

HARDI ENDURANCE 4-SHELF WALL MOUNT INSTALLATION INSTRUCTIONS

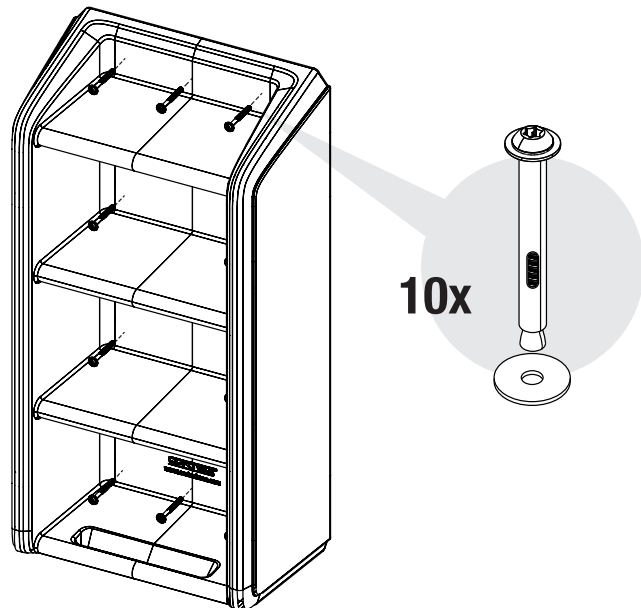

You will need:

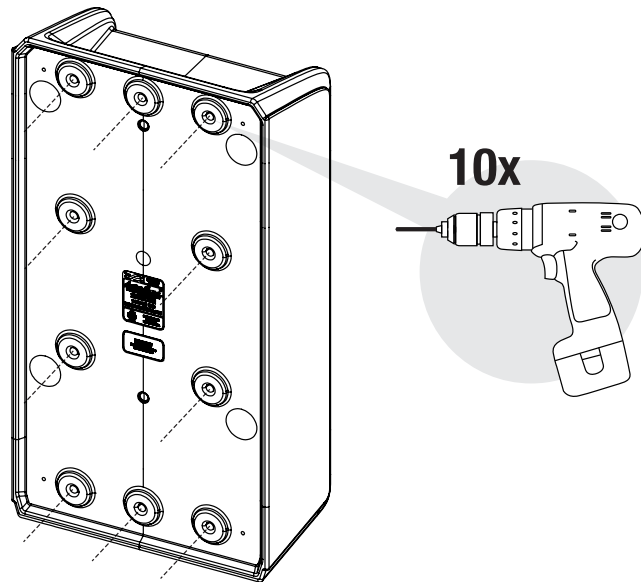

1x

Pencil
For Marking Floor And Wall

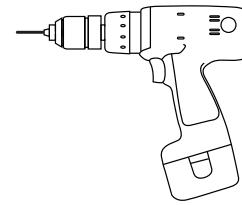

1x

Drill
With 3/8 Bit

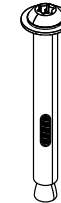

10x

3/8-16 x 3.75"
Security Torx Anchor Bolts

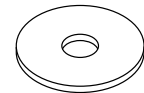

10x

Flat Washer

- 1.** Position wall shelf to access the back of the shelf.
- 2.** Select and drill all ten mounting locations on the back of the shelf.
- 3.** Locate shelf where it is to be secured to the wall.
- 4.** Using a pen or pencil, mark mounting hole locations on the wall using the holes drilled in step 2.
- 5.** Move shelf and drill holes in the ten locations where you marked the wall. Hole depth should be 2.0" deep MINIMUM.
- 6.** Replace the shelf lining up the drilled holes with the holes in the wall.
- 7.** Place one flat washer over each of the ten anchor bolt and guide the bolts through the shelf and into the holes into the wall.
- 8.** Tighten each anchor bolt 3-5 turns past finger tight.

HARDI ENDURANCE 4-SHELF WALL MOUNT INSTALLATION INSTRUCTIONS

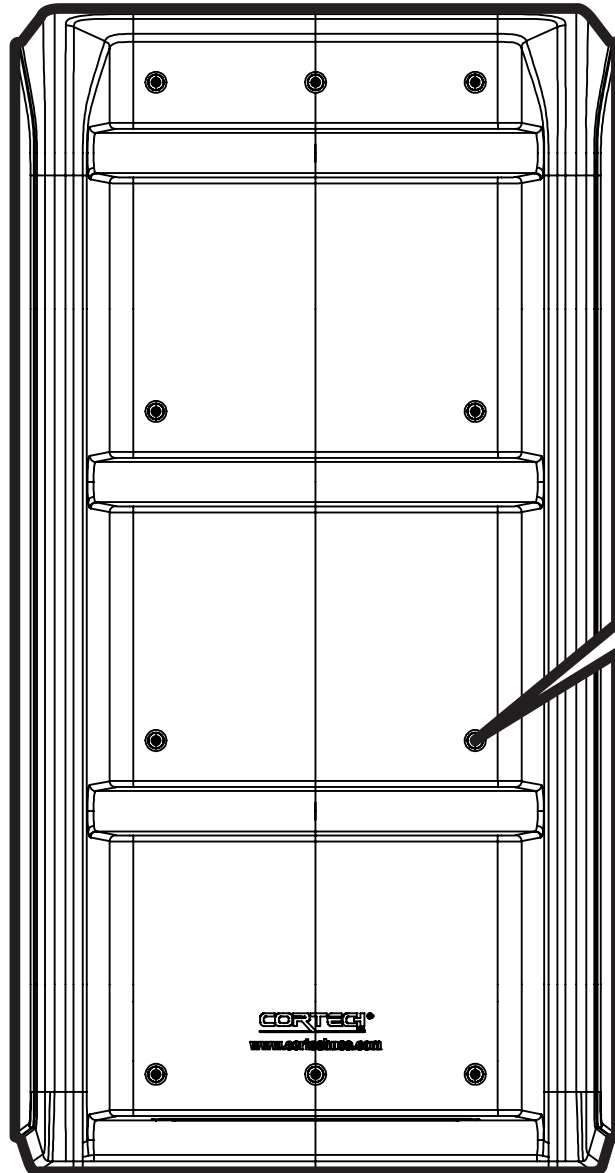
**10x**

3/8 - 16 x 3.75"
Tamper Proof Security Torx
Anchor Bolt

1. Drill a hole into base material to a depth at least 1/2" or one anchor diameter deeper than the embedment required.
2. Blow the hole clean of dust and other material.
3. Drive the anchor through the shelf into the anchor hole until the head is firmly seated against the shelf.
4. Use a rubber mallet. Be sure the anchor is driven to the required embedment depth.
5. Tighten the anchor by turning the head 3 to 5 turns past finger tight.

HARDI ENDURANCE 4-SHELF WALL MOUNT INSTALLATION INSTRUCTIONS

Bolt Locations

