

MANHATTAN

Height Adjustable

Assembly and Power Instructions

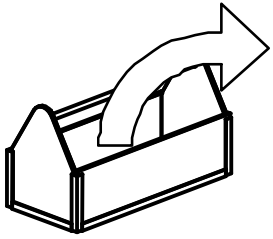

#2



#3

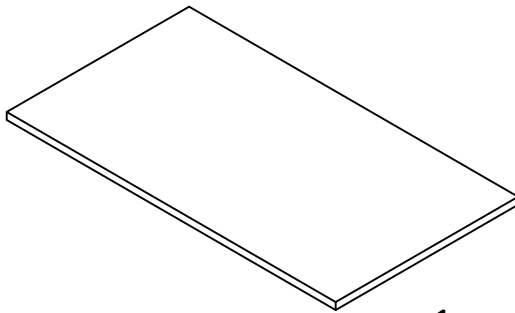

x1

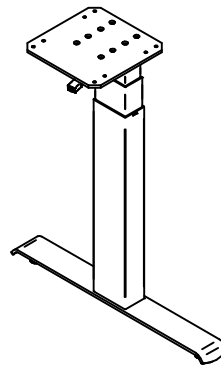

x2

HDW-0028
#12 x 7/8" Wood Screw



x16

POWER COMPONENTS



x2

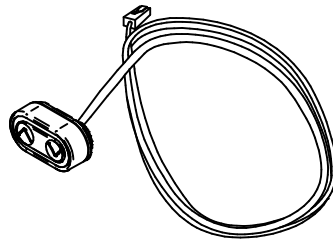

x1

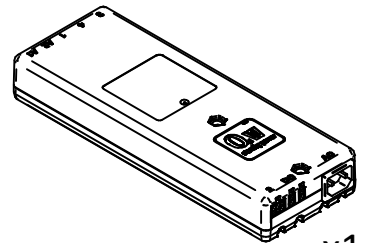

x1

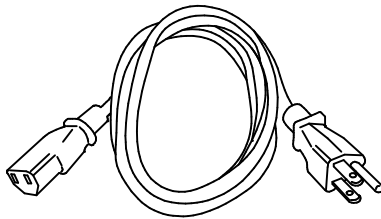

x1

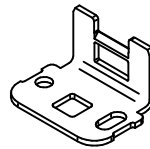

x1

HDW-0081
#8 x 1-1/2" Wood Screw



x2

HDW-0404
#10 x 9/16" Wood Screw



x2

Note: Do not over-tighten fasteners.

1

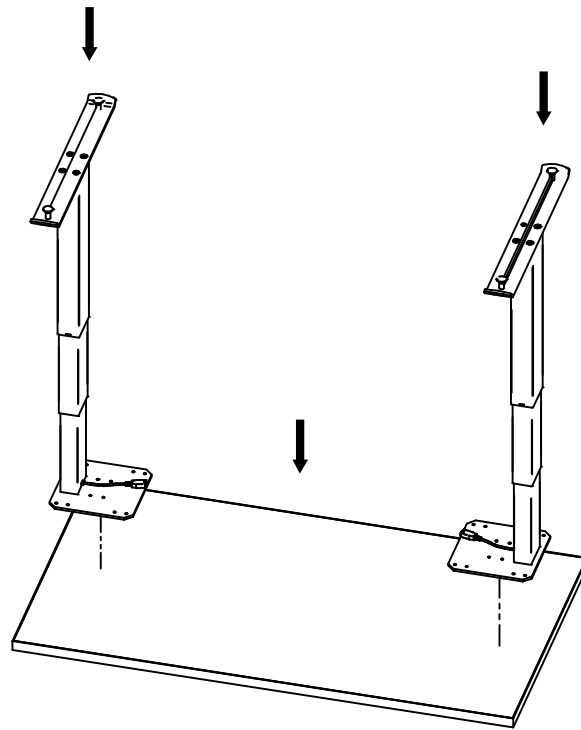
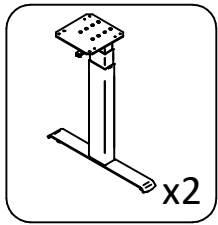

2

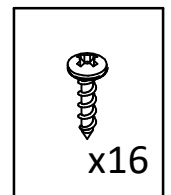
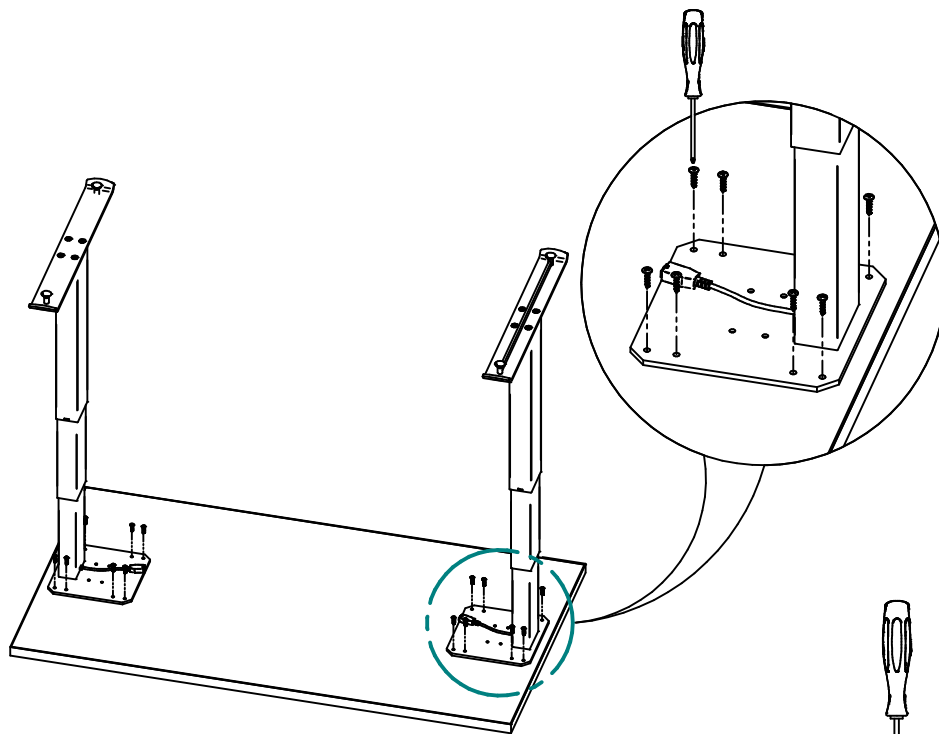

3

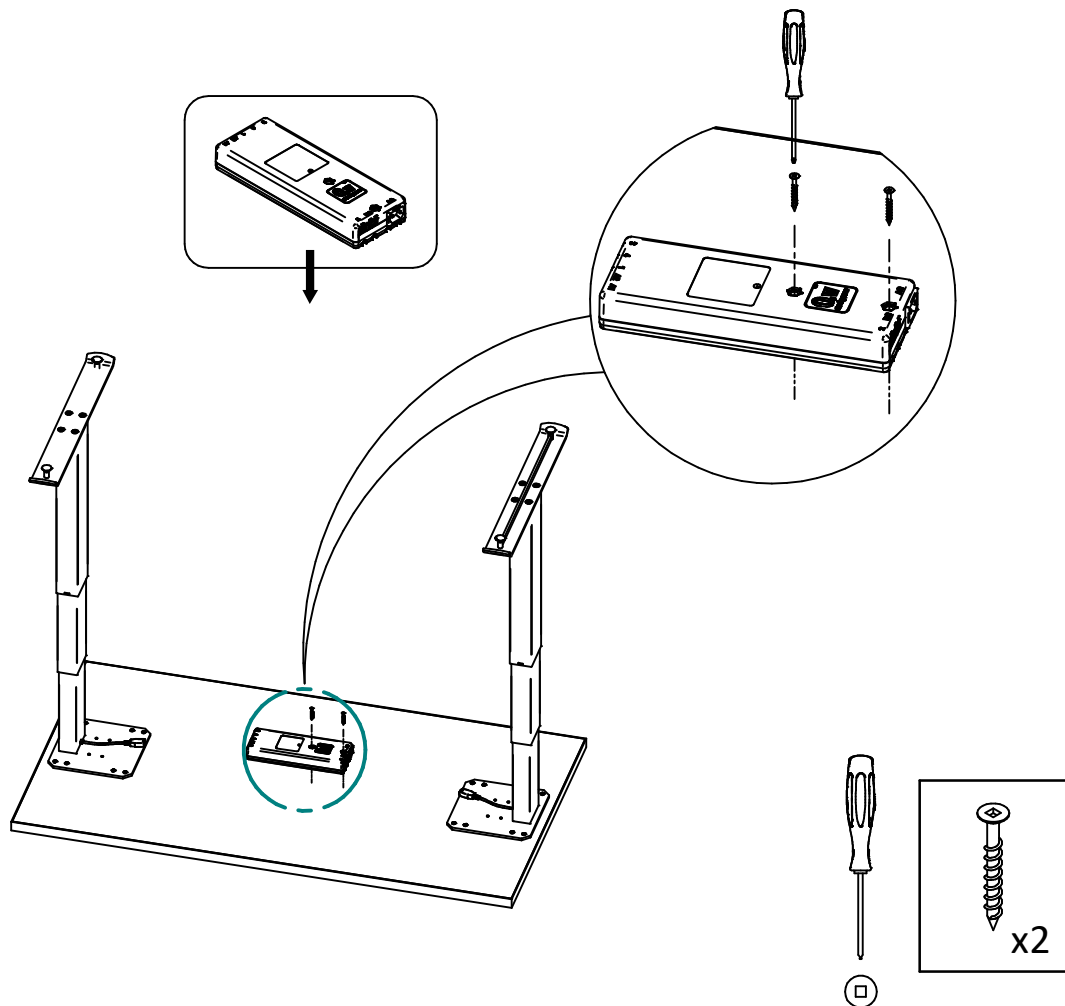

4

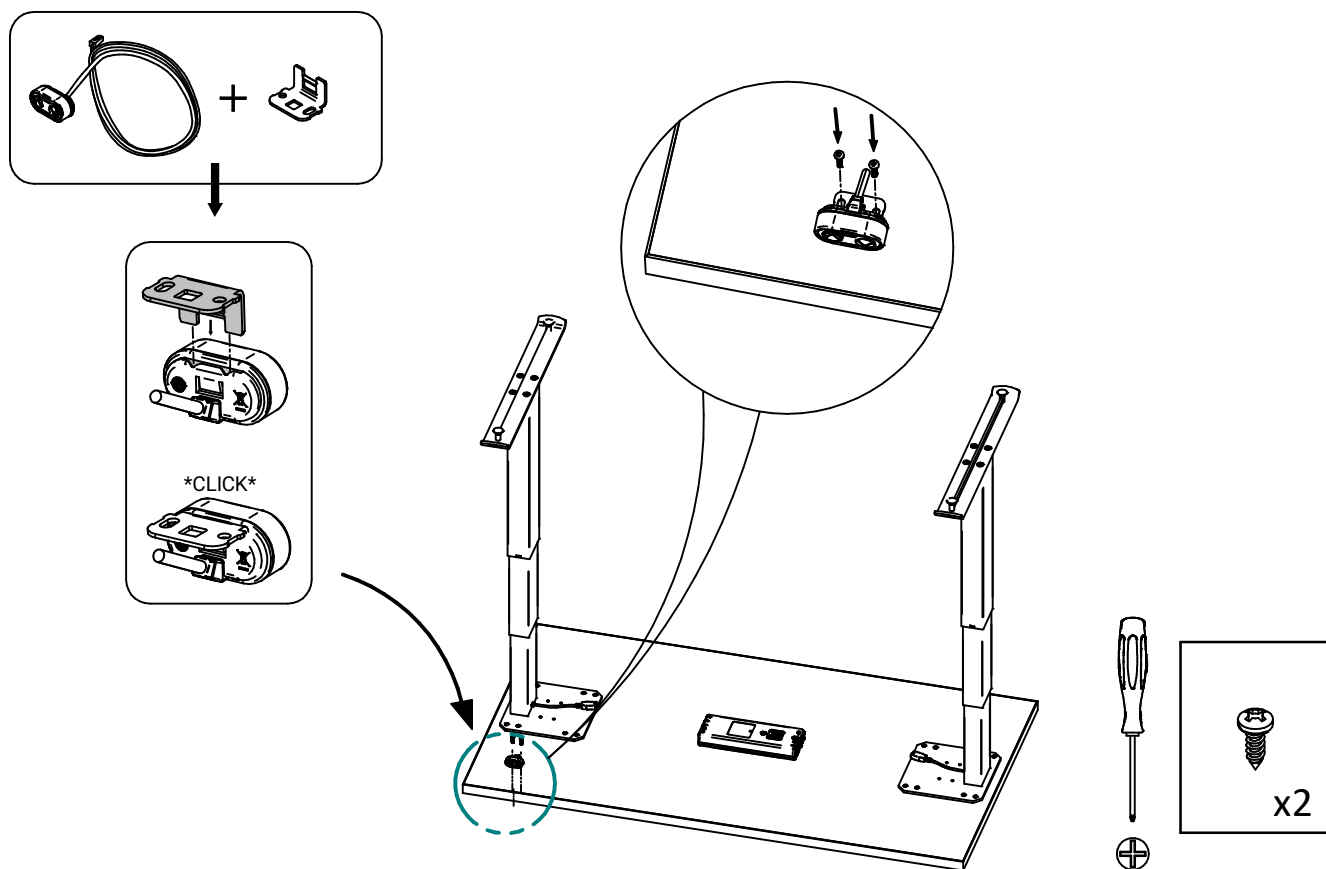

POWER INSTRUCTIONS

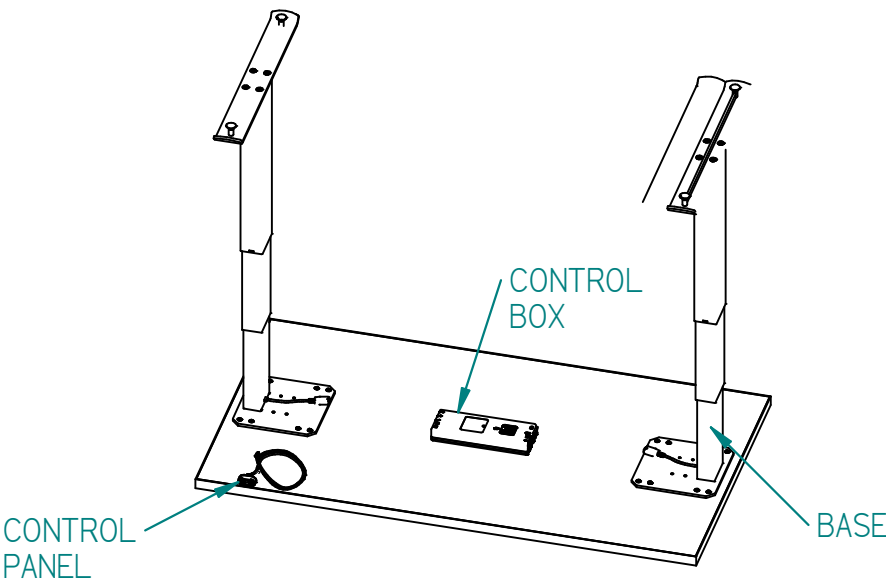

NOTE: CONTROL PANEL and BASES must be connected to CONTROL BOX first, before connecting to power.

1

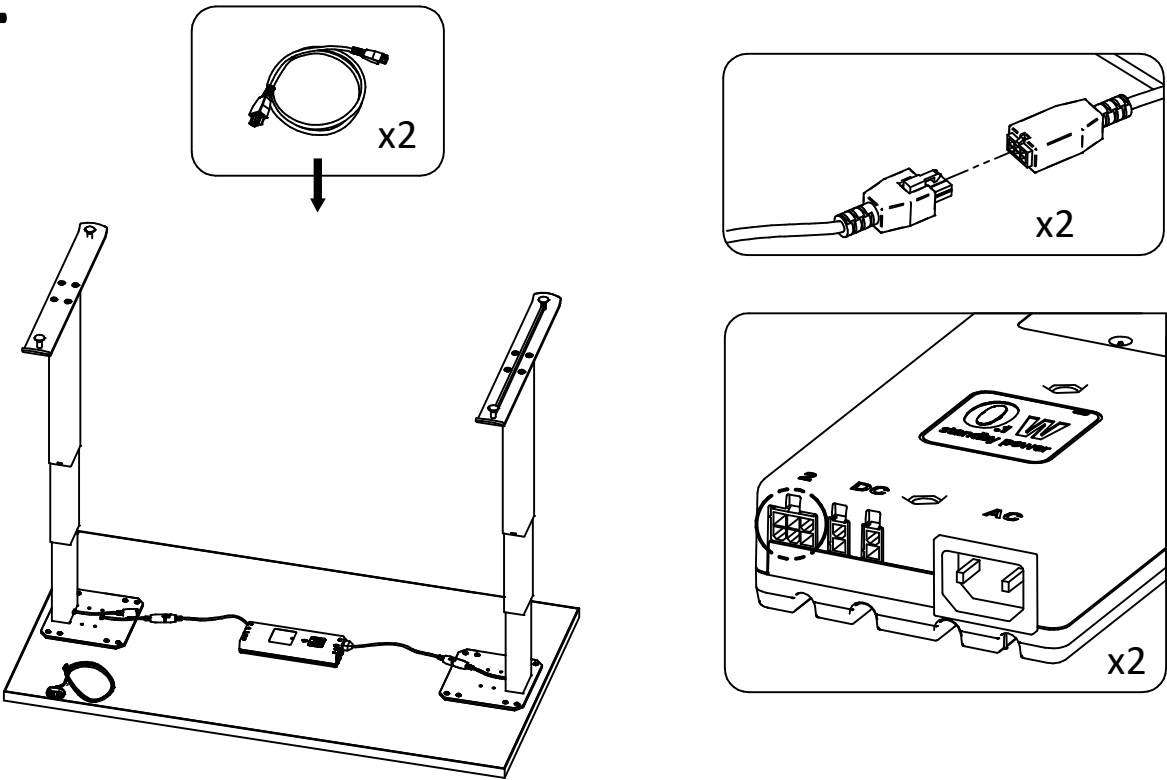

2

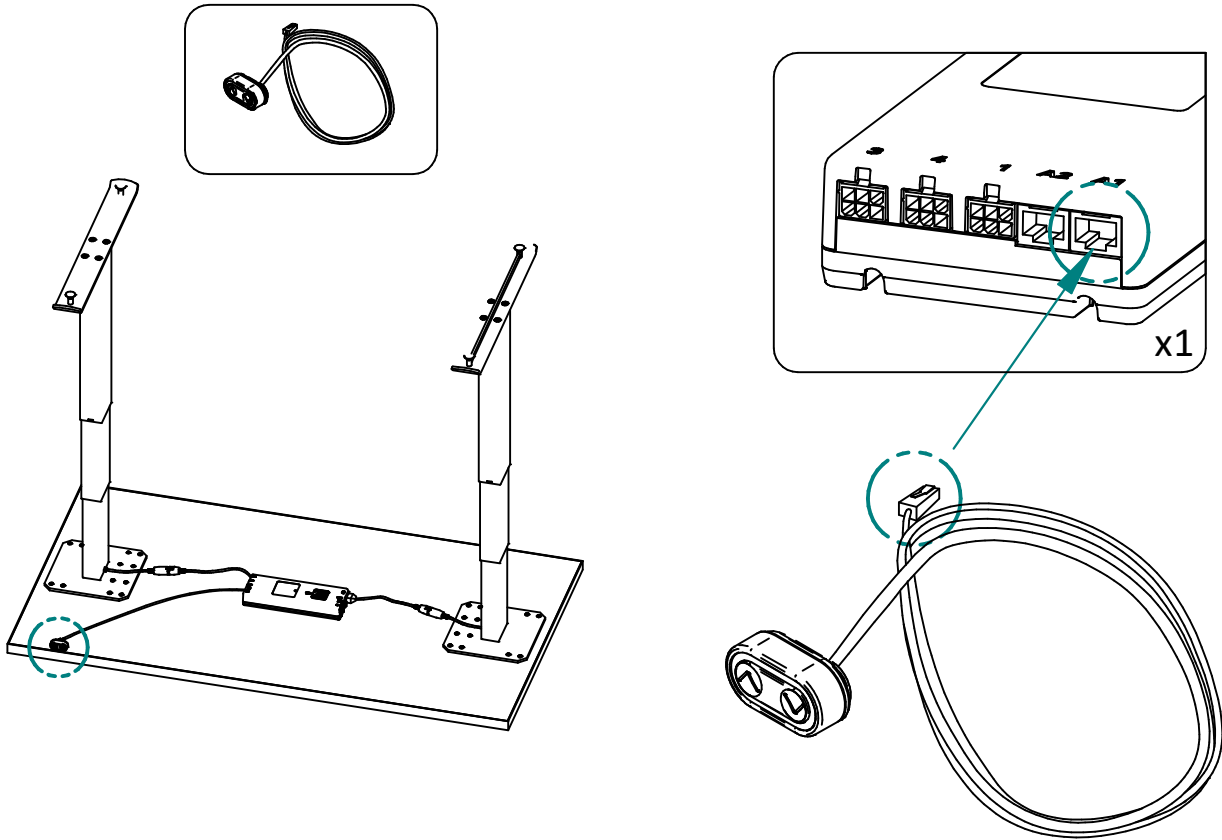

3

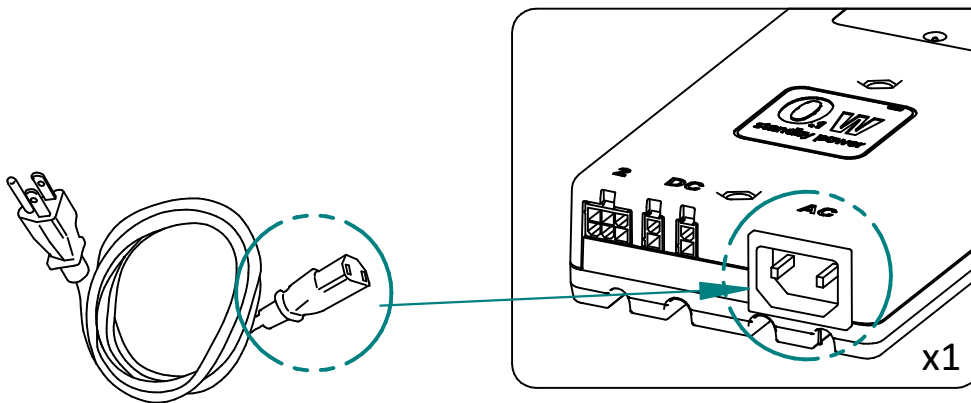

BASE ZEROING INSTRUCTIONS

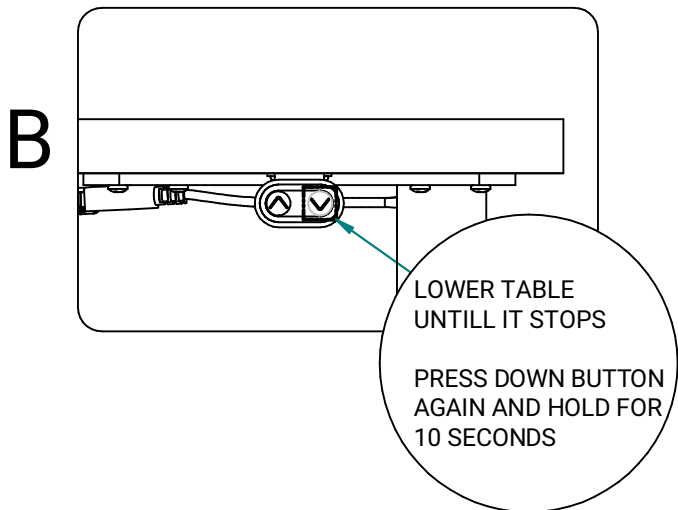
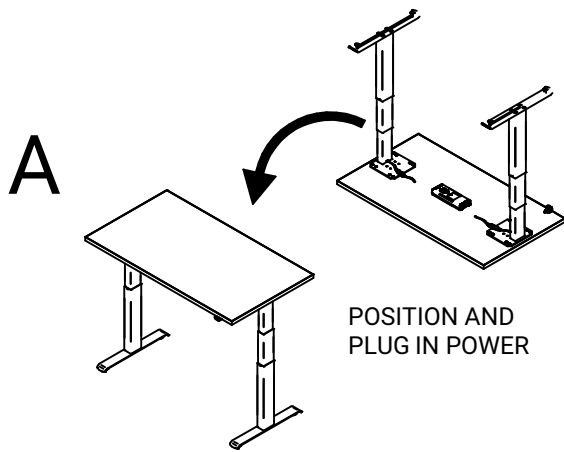

NOTE: When zeroing, table height will descend to approximately 1" below lowest table height. Be sure that there is nothing below the table that will obstruct this process.

For example, if the table height range is 27" to 35", the table will descend to just under 26" when being zeroed.

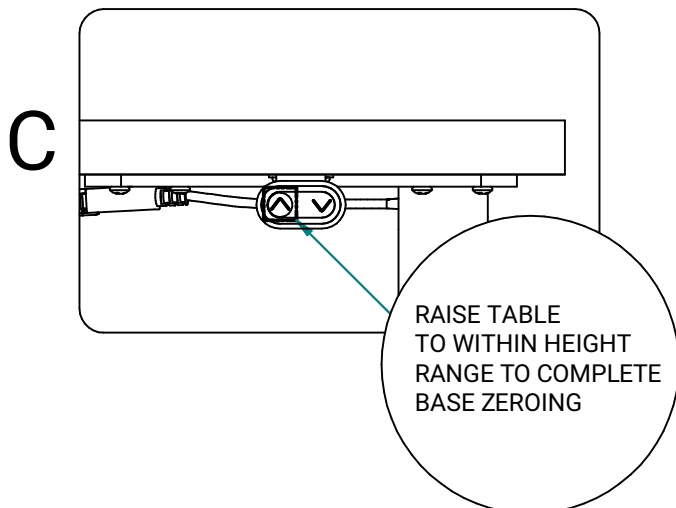

Spec Furniture Inc.

165 City View Drive, Toronto ON, M9W 5B1

P: 416.246.5540 | **F:** 416.246.5547

E: specit@specfurniture.com | specfurniture.com

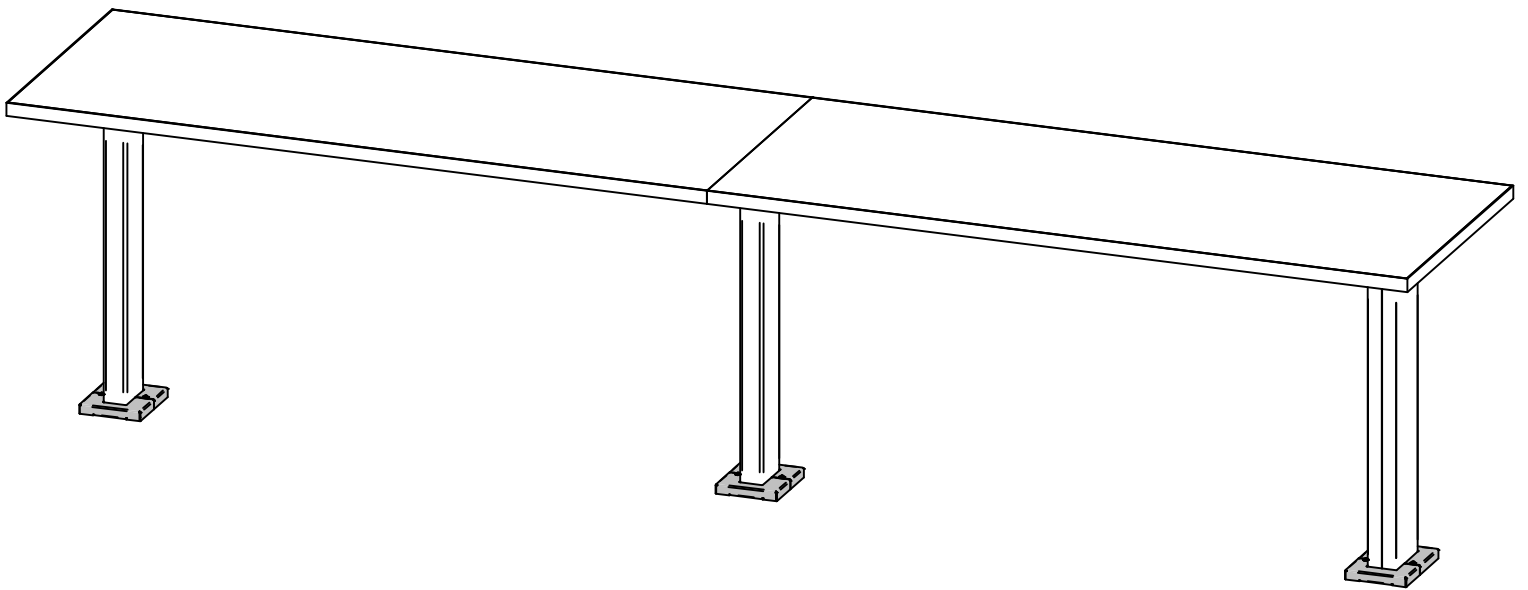

MANHATTAN

Floor Mounted Cover Plates

NOTE: Mount bases to floor prior to cover plate assembly.
Hardware for floor mounting is not provided by Spec.

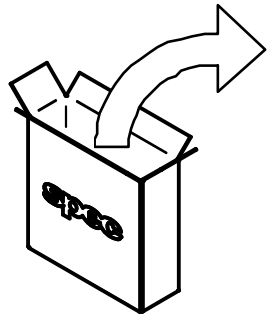
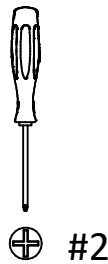
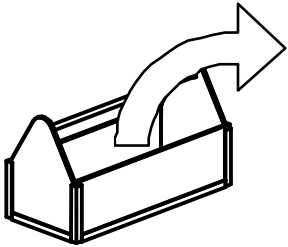

FOR RECTANGULAR POST LEGS:

STL-0565
Rectangular Post Leg Cover Plate

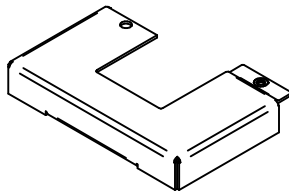

x2

HDW-1018
10-32 x 3/8" Cover Plate Screw



x2

FOR POST LEGS WITH RECTANGULAR VERTICAL WIRE MANAGER:

STL-0562
RVWM Cover Plate - Small

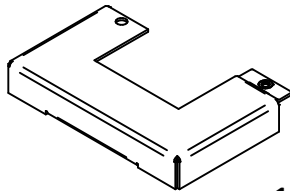

x1

STL-0563
RVWM Cover Plate - Large

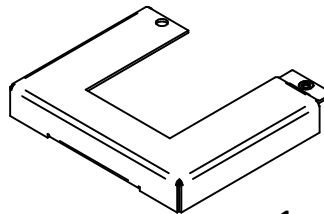

x1

HDW-1018
10-32 x 3/8" Cover Plate Screw



x2

Note: Do not over-tighten fasteners.

NOTE: Mount bases to floor prior to assembly. Hardware for floor mounting is not provided by Spec.

1

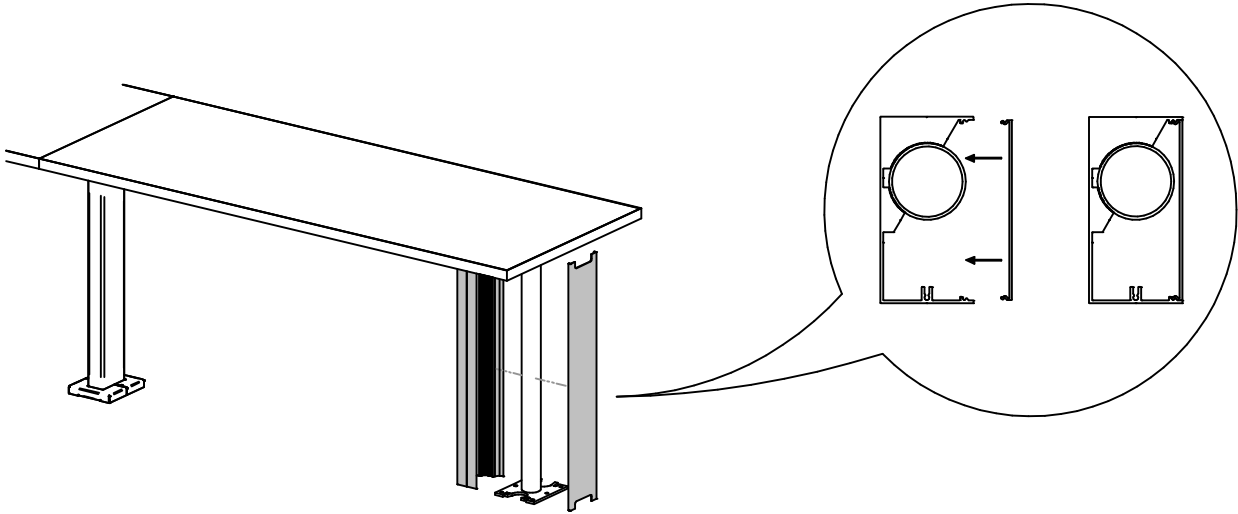

FOR POST LEGS WITH RECTANGULAR VERTICAL WIRE MANAGER:
attach Rectangular Vertical Wire Managers first.

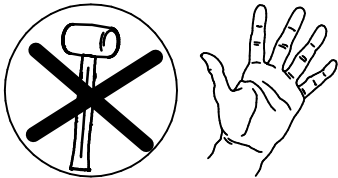

2

POST LEGS WITH RECTANGULAR
VERTICAL WIRE MANAGER

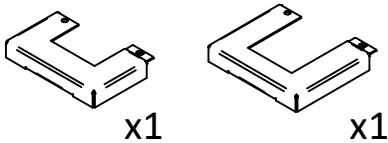

RECTANGULAR POST LEGS

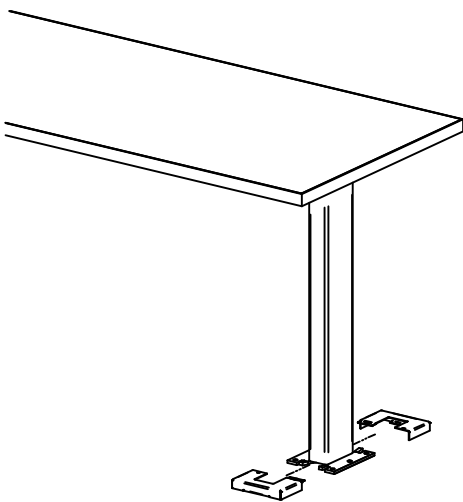
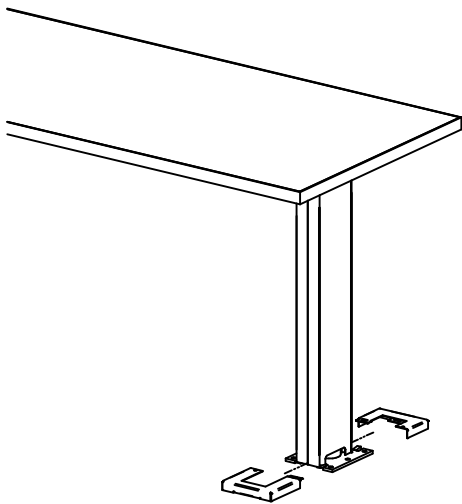
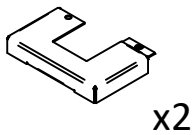

3

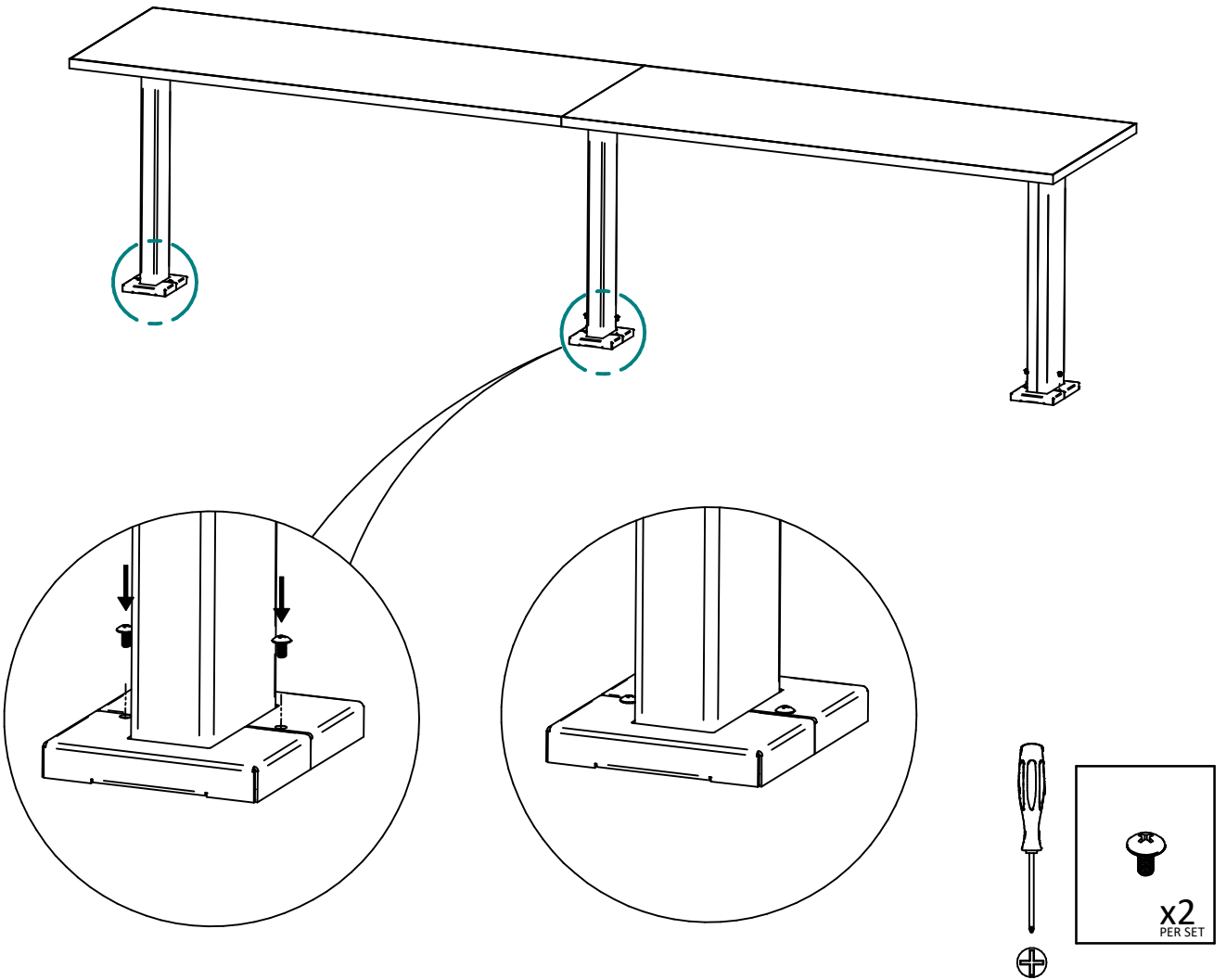

Spec Furniture Inc.
165 City View Drive, Toronto ON, M9W 5B1
P: 416.246.5540 | **F:** 416.246.5547
E: specit@specfurniture.com | specfurniture.com

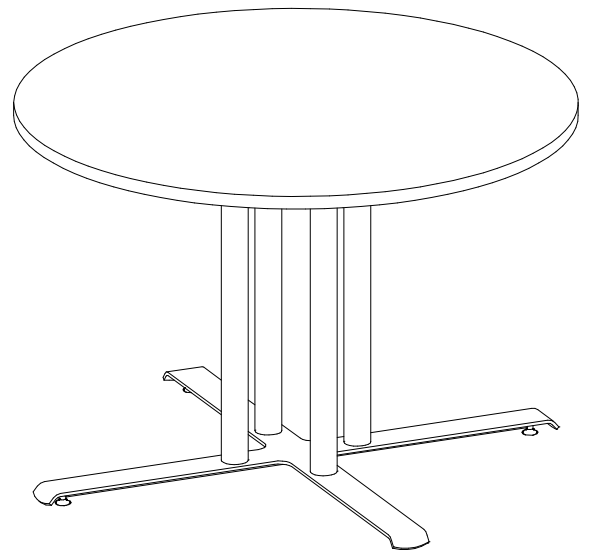

MANHATTAN

Four Column X Base Installation Instructions

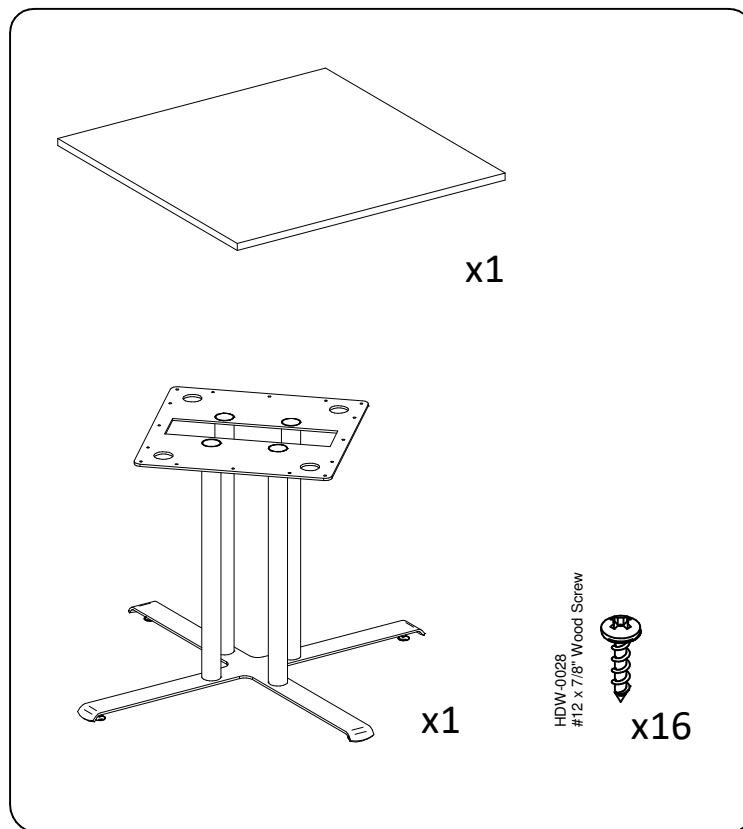
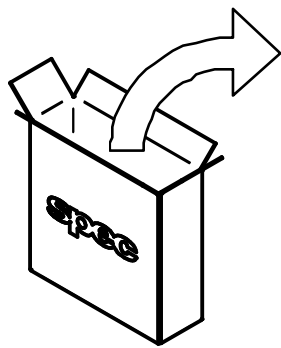
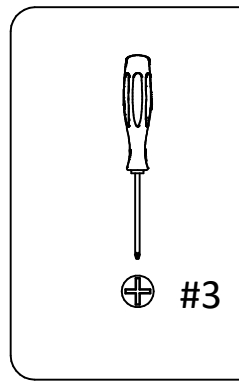
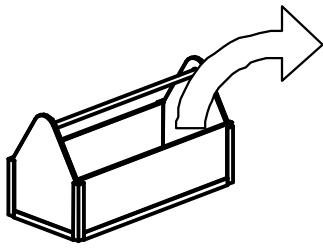

Note: Do not over-tighten fasteners.

1

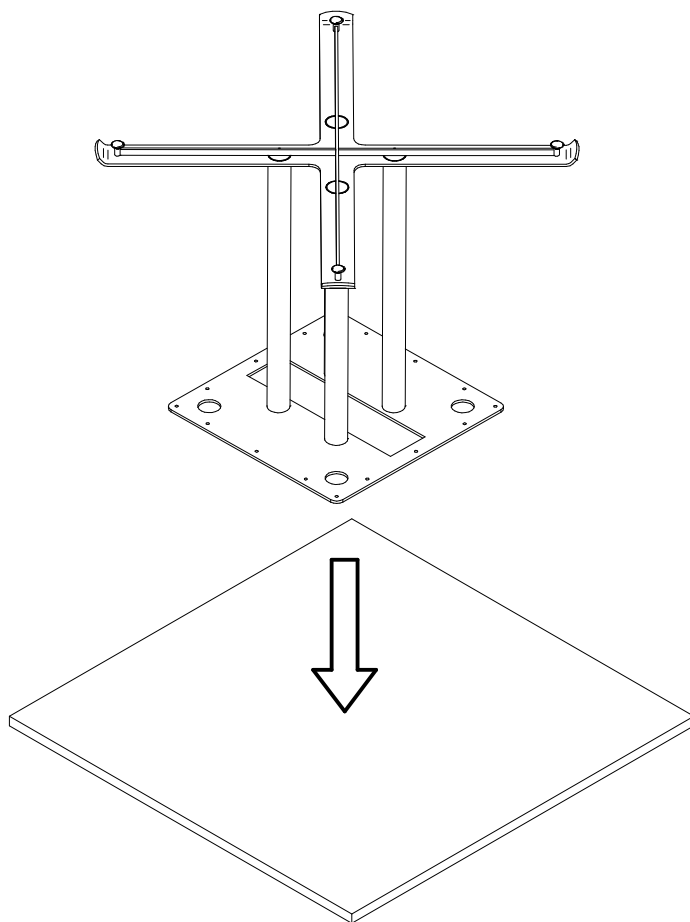

2

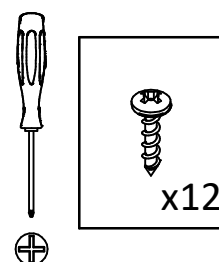
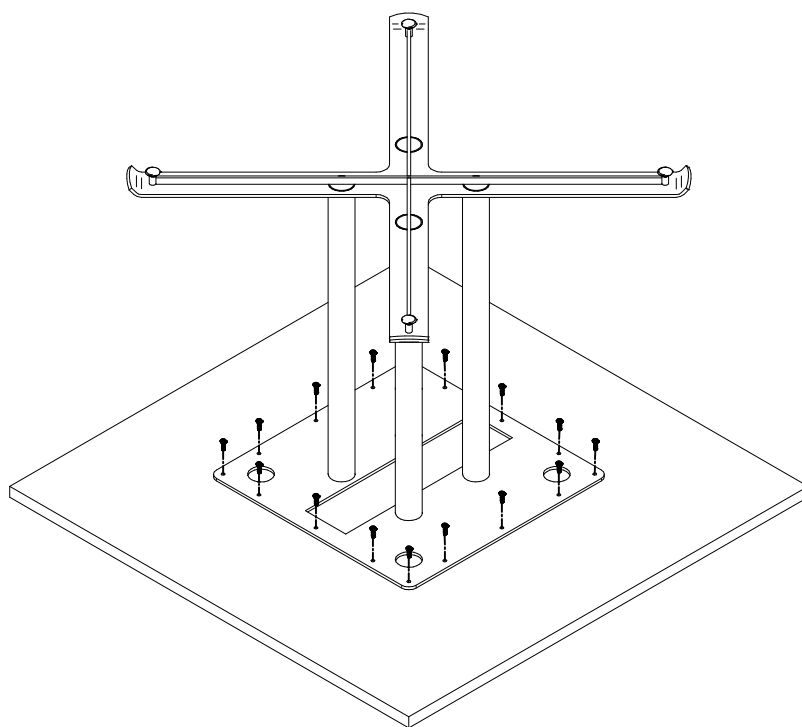

3

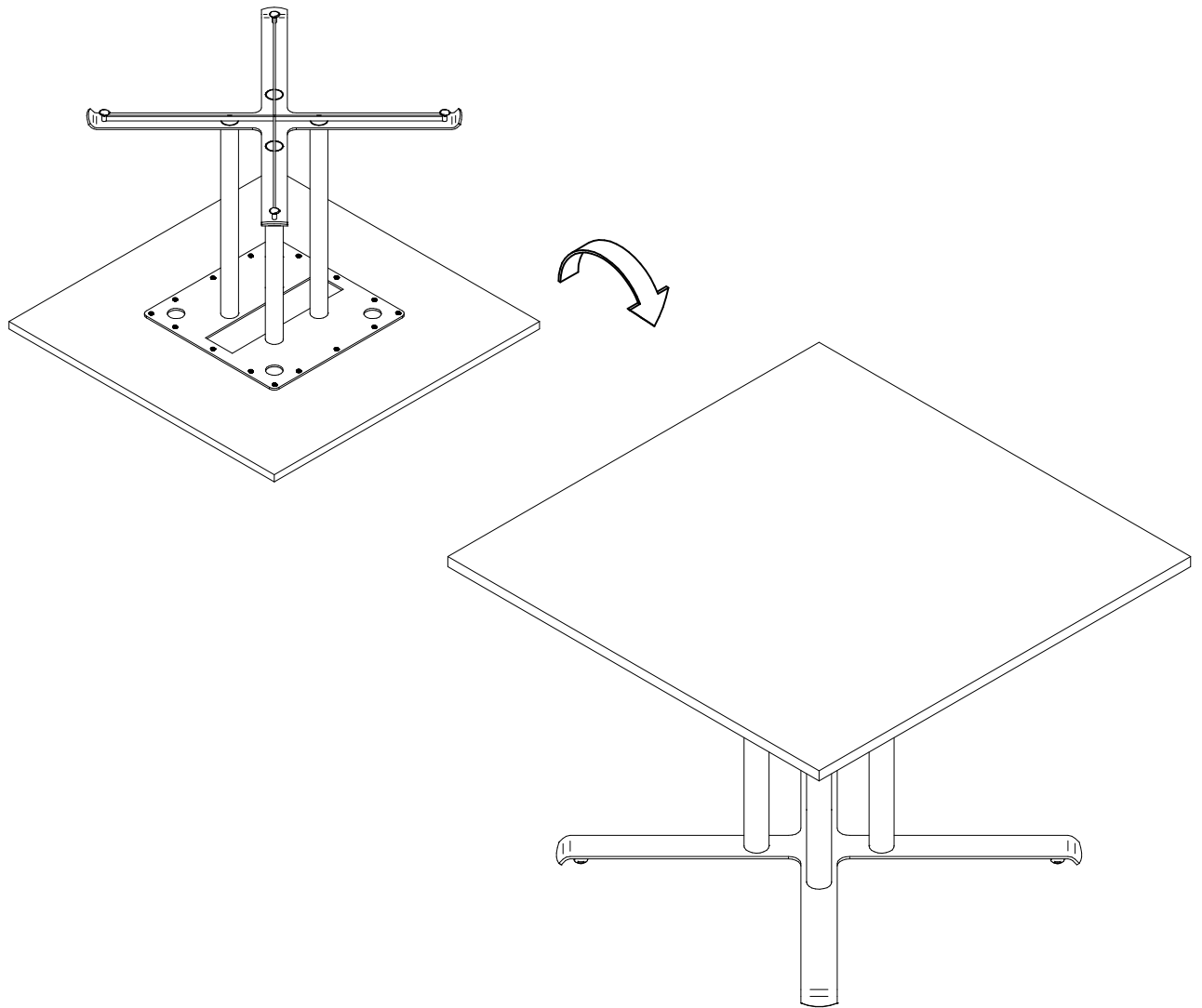

Spec Furniture Inc.
165 City View Drive, Toronto ON, M9W 5B1
P: 416.246.5540 | **F:** 416.246.5547
E: specit@specfurniture.com | specfurniture.com