

CALVIN Public Seating

LAYOUTS



Description

- Spec's Calvin offers an oval steel frame with either wood or aluminum side rails.
- Your layout possibilities are unlimited with spacer, radius and corner tables for both standard and bariatric seating in virtually any combination.
- Bariatric seating is a 30" wide seat and is load tested to 750 lbs. Cannot be connected to other bariatric seats.
- 21" seat width is standard.
- Choice of wood, polyurethane or Corian arms, replaceable in the field.
- Two and three seat models offer a choice of no center arms or half arms between seats.
- Glides and separate seat and back are standard.
- Please send a drawing of the configuration you require with your order.
- Ships assembled as one, two and three seater units.
- For fabrics you wish railroaded or repeats larger than 5" x 5", please contact the factory with repeat information and yardage requirement will be provided.

LAYOUTS AND DIMENSIONS

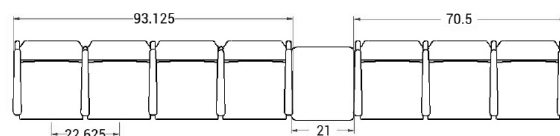
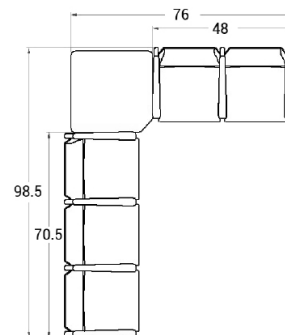
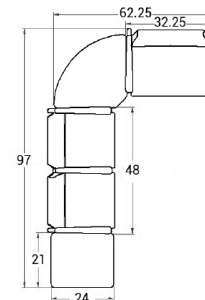

CALVIN Public Seating



PRODUCT CODE

8101M
Series

81 : Calvin

Center Arm

 0 : No center arm
 1 : Half arms

Seats

 1 : Single Seat
 2 : Two-Seat
 3 : Three-Seat

Chair Type

 M : Mid Back
 H : Highback
 G : Bariatric
 L : Loveseat
 ME : Hip Chair

OPTIONS

SIDE RAIL



Wood



Aluminium

ARMS



Wood



Polyurethane



Corian

FINISHES

FRAME



Select from one of our 76 standard Spectone colors

FABRIC



Select fabrics from one of our textile partners

ARMS



Black



Sterling Grey



Select from one of 5 Corian finishes



Taupe

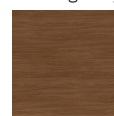

Select from one of our 9 standard wood stains or stain-to-match for no extra charge

 See Spectone Card or specfurniture.com/tools-and-resources/product-resources/finishes for a complete list of finish options and colors.



CALVIN Public Seating

HOW TO ORDER

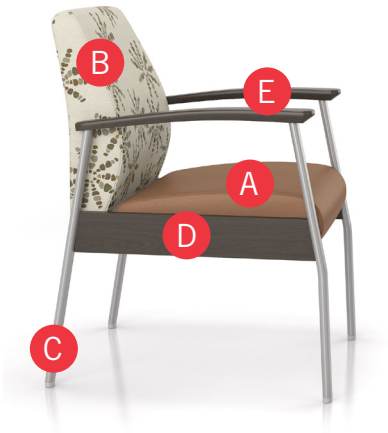

Specify Model

- A Specify Fabric - Seat
Manufacturer, Pattern Name, Color
- B Specify Fabric - Back
Manufacturer, Pattern Name, Color
- C Specify Frame Finish
- D Specify Side Rail Type and Color
- E Specify Arm Type and Color

Optional: Wood Side Frame, CAL 133 Fire Barrier, Moisture Barrier, Connecting and Freestanding Tables, Vinyl Headrest Insert, Corian Arms



Model	Fabric - Seat	Fabric - Back	Frame Finish	Side Rail Type and Color	Arm Type and Color
8101M	Momentum, Icon, Lacquer	Momentum, Estrella, Lumen	Silver	Wood, Asian Night Stain	Wood, Asian Night Stain

CALVIN Public Seating

Single Seater with arms

Standard Features

- Separate seat and back
- Polyurethane arms or wood arms
- Arms are field replaceable
- Wall-saving, 14 gauge oval tube frame
- Frame in any Spectone color
- VELCRO® removable back covers, replaceable seat
- Used in connected layouts for no extra charge
- Glides
- Ships assembled
- Ships 1/carton 15 cu ft

For fabrics you wish railroaded or repeats larger than 5" x 5", please contact the factory. Yardage requirement will be provided.

Options

- Choose aluminum (A) or wood (W) side frame. Aluminum side frame available in any Spectone color
- For wood (W) side frame, specify and add \$143 list Available in any of 9 standard stains or stain-to-match for no extra charge
- Polyurethane arms available in Black, Sterling Grey or Taupe (RAL 7006)
- Wood arms in Beech are available in any of 9 standard stains or stain-to-match for no extra charge
- Corian arms available in Antarctica, Bisque, Cameo White, Glacier White, or Linen. Add \$332 List per chair. Custom colors available, contact Spec for pricing
- Connected and freestanding tables
- Antibacterial and antimicrobial fabrics available
- Different fabric on seat and back for no extra charge
- CAL 133 fire barrier, add \$147 List per chair



Single Seater with arms

COM 1.75 yds

0.75 yd COM per single seat

1.0 yd COM per single back

MODEL	COM	GR 1	GR 2	GR 3	GR 4	GR 5	GR 6
8101M	1214	1344	1381	1474	1599	1701	1833

Dimensions (inches)

seat H	18.0	seat W	21.0	arm H	25.0
total H	33.75	total W	25.0	depth	26.0



8101M

CALVIN Public Seating

Two and Three Seaters with outside arms

Standard Features

- Separate seat and back
- Polyurethane arms or wood arms
- Arms are field replaceable
- Wall-saving, 14 gauge oval tube frame
- Frame in any Spectone color
- VELCRO® removable back covers, replaceable seat
- Used in connected layouts for no extra charge
- Glides
- Ships assembled as 2 or 3 seaters
- Ships 1/carton 26 cu ft (2 seater),
1/carton 39 cu ft (3 seater)

For fabrics you wish railroaded or repeats larger than 5" x 5", please contact the factory. Yardage requirement will be provided.

Options

- Choose aluminum (A) or wood (W) side frame. Aluminum side frame available in any Spectone color
- For wood (W) side frame, specify and add \$143 list Available in any of 9 standard stains or stain-to-match for no extra charge
- Polyurethane arms available in Black, Sterling Grey or Taupe (RAL 7006)
- Wood arms in Beech are available in any of 9 standard stains or stain-to-match for no extra charge
- Corian arms available in Antarctica, Bisque, Cameo White, Glacier White, or Linen. Add \$332 List for 8102M/8103M. Custom colors available, contact Spec for pricing
- Connected and freestanding tables
- Antibacterial and antimicrobial fabrics available
- Different fabric on seat and back for no extra charge
- CAL 133 fire barrier, add \$294 List for 8102M, or \$441 List for 8103M

**Two Seater with outside arms**

COM 3.5 yds

0.75 yd COM per single seat

1.0 yd COM per single back

MODEL	COM	GR 1	GR 2	GR 3	GR 4	GR 5	GR 6
8102M	1943	2201	2283	2466	2716	2917	3179

Dimensions (inches)

seat H	18.0	seat W	21.0	arm H	25.0
total H	33.75	total W	44.75	depth	26.0

**8102M****Three Seater with outside arms**

COM 5.25 yds

0.75 yd COM per single seat

1.0 yd COM per single back

MODEL	COM	GR 1	GR 2	GR 3	GR 4	GR 5	GR 6
8103M	2594	2980	3104	3377	3753	4055	4452

Dimensions (inches)

seat H	18.0	seat W	21.0	arm H	25.0
total H	33.75	total W	67.5	depth	26.0

**8103M**

CALVIN Public Seating

Two and Three Seaters with half arms

Standard Features

- Separate seat and back
- Polyurethane arms or wood arms
- Arms are field replaceable
- Wall-saving, 14 gauge oval tube frame
- Frame in any Spectone color
- VELCRO® removable back covers, replaceable seat
- Used in connected layouts for no extra charge
- Glides
- Ships assembled as 2 or 3 seaters
- Ships 1/carton 26 cu ft (2 seater),
1/carton 39 cu ft (3 seater)

For fabrics you wish railroaded or repeats larger than 5" x 5", please contact the factory. Yardage requirement will be provided.

Options

- Choose aluminum (A) or wood (W) side frame. Aluminum side frame available in any Spectone color
- For wood (W) side frame, specify and add \$143 list Available in any of 9 standard stains or stain-to-match for no extra charge
- Polyurethane arms available in Black, Sterling Grey or Taupe (RAL 7006)
- Wood arms in Beech are available in any of 9 standard stains or stain-to-match for no extra charge
- Corian arms available in Antarctica, Bisque, Cameo White, Glacier White, or Linen. Add \$498 List for 8112M, or \$664 List for 8113M. Custom colors available, contact Spec for pricing
- Connected and freestanding tables
- Antibacterial and antimicrobial fabrics available
- Different fabric on seat and back for no extra charge
- CAL 133 fire barrier, add \$294 List for 8112M, or \$441 List for 8113M

Two Seater with half arms

COM 3.5 yds

0.75 yd COM per single seat

1.0 yd COM per single back

MODEL	COM	GR 1	GR 2	GR 3	GR 4	GR 5	GR 6
8112M	2178	2437	2520	2700	2952	3153	3419

Dimensions (inches)

seat H	18.0	seat W	21.0	arm H	25.0
total H	33.75	total W	48.0	depth	26.0



8112M

Three Seater with half arms

COM 5.25 yds

0.75 yd COM per single seat

1.0 yd COM per single back

MODEL	COM	GR 1	GR 2	GR 3	GR 4	GR 5	GR 6
8113M	3025	3417	3537	3813	4185	4490	4887

Dimensions (inches)

seat H	18.0	seat W	21.0	arm H	25.0
total H	33.75	total W	70.5	depth	26.0



8113M

CALVIN Public Seating

Loveseat with arms

Standard Features

- Separate seat and back
- Polyurethane arms or wood arms
- Arms are field replaceable
- Wall-saving, 14 gauge oval tube frame
- Frame in any Spectone color
- VELCRO® removable back covers, replaceable seat
- Used in connected layouts for no extra charge
- Glides
- Ships assembled
- Ships 1/carton 20 cu ft

For fabrics you wish railroaded or repeats larger than 5" x 5", please contact the factory. Yardage requirement will be provided.

Options

- Choose aluminum (A) or wood (W) side frame. Aluminum side frame available in any Spectone color
- For wood (W) side frame, specify and add \$143 list Available in any of 9 standard stains or stain-to-match for no extra charge
- Polyurethane arms available in Black, Sterling Grey or Taupe (RAL 7006)
- Wood arms in Beech are available in any of 9 standard stains or stain-to-match for no extra charge
- Corian arms available in Antarctica, Bisque, Cameo White, Glacier White, or Linen. Add \$332 List per chair. Custom colors available, contact Spec for pricing
- Connected and freestanding tables
- Antibacterial and antimicrobial fabrics available
- Different fabric on seat and back for no extra charge
- CAL 133 fire barrier, add \$227 List per chair



Loveseat with arms

COM 3.5 yds

1.75 yd COM per single seat

1.75 yd COM per single back

MODEL	COM	GR 1	GR 2	GR 3	GR 4	GR 5	GR 6
8101L	1831	2087	2171	2355	2604	2808	3071

Dimensions (inches)

seat H	18.0	seat W	42.0	arm H	25.0
total H	33.75	total W	46.0	depth	26.0



8101L

CALVIN Public Seating**Bariatric Single Seater with arms****Standard Features**

- Separate seat and back
- Polyurethane arms or wood arms
- Arms are field replaceable
- Wall-saving, 14 gauge oval tube frame
- Frame in any Spectone color
- VELCRO® removable back covers, replaceable seat
- Used in connected layouts for no extra charge
- Glides
- Ships assembled
- Ships 1/carton 20 cu ft

For fabrics you wish railroaded or repeats larger than 5" x 5", please contact the factory. Yardage requirement will be provided.

Options

- Choose aluminum (A) or wood (W) side frame. Aluminum side frame available in any Spectone color
- For wood (W) side frame, specify and add \$143 list Available in any of 9 standard stains or stain-to-match for no extra charge
- Polyurethane arms available in Black, Sterling Grey or Taupe (RAL 7006)
- Wood arms in Beech are available in any of 9 standard stains or stain-to-match for no extra charge
- Corian arms available in Antarctica, Bisque, Cameo White, Glacier White, or Linen. Add \$ 332 List per chair. Custom colors available, contact Spec for pricing
- Connected and freestanding tables
- Antibacterial and antimicrobial fabrics available
- Different fabric on seat and back for no extra charge
- CAL 133 fire barrier, add \$185 List per chair

**Bariatric Single Seater with arms**

COM 3.0 yds

1.5 yd COM per single seat

1.5 yd COM per single back

MODEL	COM	GR 1	GR 2	GR 3	GR 4	GR 5	GR 6
8101G	1474	1698	1767	1925	2139	2311	2538

Dimensions (inches)

seat H	18.0	seat W	30.0	arm H	25.0
total H	33.75	total W	34.0	depth	26.0



8101G

CALVIN Public Seating**Highback Single Seater with arms****Standard Features**

- Separate seat and back
- Polyurethane arms or wood arms
- Arms are field replaceable
- 14 gauge oval tube frame
- Frame in any Spectone color
- VELCRO® removable back covers, replaceable seat
- Used in connected layouts for no extra charge
- Glides
- Ships assembled
- Ships 1/carton 20 cu ft

For fabrics you wish railroaded or repeats larger than 5" x 5", please contact the factory. Yardage requirement will be provided.

Options

- Choose aluminum (A) or wood (W) side frame. Aluminum side frame available in any Spectone color
- For wood (W) side frame, specify and add \$143 list Available in any of 9 standard stains or stain-to-match for no extra charge
- Polyurethane arms available in Black, Sterling Grey or Taupe (RAL 7006)
- Wood arms in Beech are available in any of 9 standard stains or stain-to-match for no extra charge
- Corian arms available in Antarctica, Bisque, Cameo White, Glacier White, or Linen. Add \$ 332 List per chair. Custom colors available, contact Spec for pricing
- Vinyl insert on top of the back, add \$53 List per chair
- Connected and freestanding tables
- Antibacterial and antimicrobial fabrics available
- Different fabric on seat and back for no extra charge
- CAL 133 fire barrier, add \$166 List per chair

**Highback Single Seater with arms**

COM 2.5 yds

0.75 yd COM per single seat

1.75 yd COM per single back

MODEL	COM	GR 1	GR 2	GR 3	GR 4	GR 5	GR 6
8101H	1307	1493	1553	1684	1861	2008	2196

Dimensions (inches)

seat H	18.0	seat W	21.0	arm H	25.0
total H	47.50	total W	25.0	depth	26.0

**8101H**

CALVIN Public Seating

Easy Access Hip Single Seater with arms

Standard Features

- Separate seat and back
- Polyurethane arms or wood arms
- Arms are field replaceable
- Wall-saving, 14 gauge oval tube frame
- Frame in any Spectone color
- VELCRO® removable back covers, replaceable seat
- Used in connected layouts for no extra charge
- Glides
- Ships assembled
- Ships 1/carton 20 cu ft

For fabrics you wish railroaded or repeats larger than 5" x 5", please contact the factory. Yardage requirement will be provided.

Options

- Choose aluminum (A) or wood (W) side frame. Aluminum side frame available in any Spectone color
- For wood (W) side frame, specify and add \$143 list Available in any of 9 standard stains or stain-to-match for no extra charge
- Polyurethane arms available in Black, Sterling Grey or Taupe (RAL 7006)
- Wood arms in Beech are available in any of 9 standard stains or stain-to-match for no extra charge
- Corian arms available in Antarctica, Bisque, Cameo White, Glacier White, or Linen. Add \$332 List per chair. Custom colors available, contact Spec for pricing
- Connected and freestanding tables
- Antibacterial and antimicrobial fabrics available
- Different fabric on seat and back for no extra charge
- CAL 133 fire barrier, add \$147 List per chair

**Easy Access Hip Single Seater with arms**

COM 1.75 yds

0.75 yd COM per single seat

1.0 yd COM per single back

MODEL	COM	GR 1	GR 2	GR 3	GR 4	GR 5	GR 6
8101ME	1344	1472	1512	1603	1729	1831	1965

Dimensions (inches)

seat H	24.0	seat W	21.0	arm H	31.5
total H	46.0	total W	25.0	depth	26.0

**8101ME**

CALVIN Public Seating

Freestanding Lounge Tables – Corner and Spacer Connecting Tables

Standard Features

- Tops in laminate or veneer
- Select laminate tops from 15 standard laminates or choose any standard Wilsonart, Nevamar, Formica, Arborite and Pionite matte finish laminates for no extra charge
- Freestanding lounge tables available with PVC Flat (PVF), 2mm (2MM), exposed Baltic Birch plywood (PF, PKNR) or hardwood (HB) edge
- Connecting table tops available with PVC Flat (PVF), 2mm (2MM), Self edge (SE) or hardwood (HB) edge
- 9 standard veneer and hardwood edge stains. Stain-to-match available for no extra charge.
- Oval steel table legs available in any Spectone color
- Threaded replaceable glides
- 18" height

Options

- Custom size spacer tables for restricted spaces
- Other sizes may be available

Radius Corner Tables are recommended for open areas



Freestanding Lounge Tables

Model	Laminate PVF/SE/2MM	Laminate PF/PKNR/HB	Veneer HB	Cu.Ft.
81 - 24 x 24 SQ	799	1051	1252	7.2
81 - 24 x 48 RE	1007	1286	1566	18
81 - 30 x 30 SQ	938	1121	1333	13.5
81 - 22 DIA	1005	1470	1734	7.2



Corner and Spacer Connecting Tables

Model	Laminate PVF/SE/2MM	Laminate HB Edge	Veneer HB Edge	Cu.Ft.
81RC - 28 x 28 <i>Radius Corner Table</i>	1056	1415	1660	2
81SC - 28 x 28 <i>Square Corner Table</i>	1153	1401	1545	2
81TC - 45 degree <i>Corner Table</i>	1056	1415	1660	2
81ST - 21 x 21 <i>Spacer Table</i>	716	1011	1159	2
81ET - 21 x 21 <i>End Table</i>	957	1251	1400	2

