



Pricing March 1, 2020
Discount 57.7% from List prices



MAS SIN 33721

COOPER COLLECTION - BALA Lounge Seating

LAYOUTS



Description

- Spec's Bala offers the softer look and feel of wood, without sacrificing high durability.
- Your layout possibilities are unlimited with spacer, radius and corner tables – for both standard and bariatric seating in virtually any combination.
- Bariatric seating is a 30" wide seat and is load tested to 750 lbs. Cannot be connected to other bariatric seats.
- 21" seat width is standard.
- Standard in European Beech in any of 9 standard stains or stain-to-match at no upcharge.
- Choice of wood or polyurethane arms which are replaceable in the field.
- All models offer a choice of no center arms, half arms or full arms to the floor.
- Glides and separate seat and back are standard.
- Please send a drawing of the configuration you require with your order.
- For fabrics you wish railroaded or repeats larger than 5" x 5", please contact the factory with repeat information and yardage requirement will be provided.



LAYOUTS AND DIMENSIONS

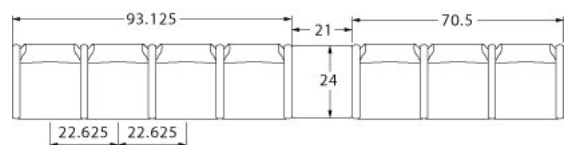
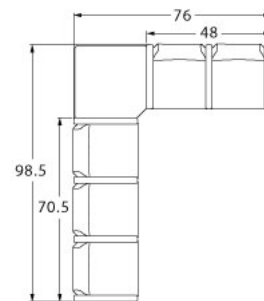
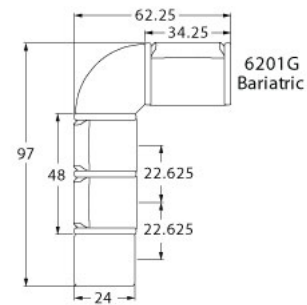



Pricing March 1, 2020
Discount 57.7% from List prices



MAS SIN 33721

COOPER COLLECTION - BALA Lounge Seating



PRODUCT CODE

6 2 2 3 M - WF

Collection

6 : Cooper

Series

2 : Bala

Center Arm

0 : Outside Arms
1 : Half Arms
2 : Full Arms

Number of Seats

1 : Single Seater
2 : Two Seater
3 : Three Seater

Chair Type

M : Mid Back
H : Highback
G : Bariatric
ME : Hip Chair
B : Bench
BG : Bariatric Bench
L : Loveseat

Arm Type and Profile

WF : Wood Flat
WR : Wood Round
PF : Poly Flat
PR : Poly Round
K: KYDEX® Flat Profile



OPTIONS

ARM TYPE



Polyurethane



Wood



KYDEX®

PANEL ARMS



Half Panel Arm



Full Panel Arm

FINISHES

FRAME



Select from one of our 9 standard wood stains or stain-to-match at no upcharge

FABRIC



Select fabrics from one of our textile partners

ARMS



Black

Sterling Grey

Taupe

Select from one of our 9 standard wood stains or stain-to-match at no upcharge

Note: flat polyurethane arm available in Black only.

See Spectone Card or specfurniture.com/materials/finishes for a complete list of finish options and colors.



Pricing March 1, 2020
Discount 57.7% from List prices



MAS SIN 33721

COOPER COLLECTION - BALA Lounge Seating

HOW TO ORDER

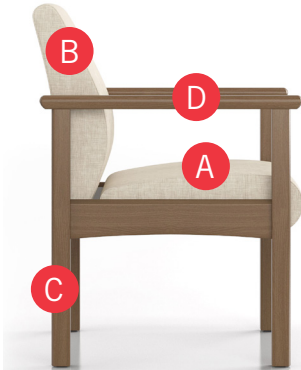

Specify Model

- A** Specify Fabric - Seat¹
Manufacturer, Pattern Name, Color
- B** Specify Fabric - Back¹
Manufacturer, Pattern Name, Color
- C** Specify Frame Finish
- D** Specify Arm Type, Profile and Color
Polyurethane (Flat or Round) / Wood (Flat or Round) / KYDEX® (\$) (Flat)

Optional: KYDEX® Arm, CAL 133, Moisture Barrier, Half or Full Panel Arms, Connecting and Freestanding Tables, Benches, Ottoman, Vinyl Headrest Insert

¹ When multiple fabrics are specified on two and three seat chairs, please provide a drawing and legend for fabric placement.



Model	Fabric - Seat	Fabric - Back	Frame Finish	Arm Type, Profile and Color
6201M	Momentum, Beeline, Canvas	Momentum, Beeline, Canvas	Studio Teak Stain	Wood, Flat, Studio Teak Stain



Pricing March 1, 2020
Discount 57.7% from List prices



MAS SIN 33721

COOPER COLLECTION - BALA Lounge Seating

Designed for today's healthcare facilities
Single Seater with arms

Standard Features

- Separate seat and back
- Wood components in Beech, in any of 9 standard stains or stain-to-match at no upcharge
- Threaded replaceable glides
- Use in connected layouts at no upcharge
- Velcro removable back covers
- Replaceable seats
- Arms replaceable in the field
- Ships assembled
- Ships 1/carton 15 cu ft

Contact Spec Customer Service to railroad fabrics (specify repeat info and yardage requirement will be provided) and for repeats greater than 5" x 5"

Options

- Wood or polyurethane arms available in flat (WF or PF) or rounded (WR or PR) profile
- Round polyurethane arms available in Black, Sterling Grey and Taupe (RAL 7006)
- Flat polyurethane arms available in Black only
- KYDEX® flat arms available in Black (B) or Taupe RAL 7006 (T) or Sterling Grey (G)
- Connected and freestanding tables
- Antibacterial and antimicrobial fabrics available
- Different fabric on seat and back at no upcharge
- CAL 133



Single Seater with arms

COM 1.75 yds
0.75 yd COM per single seat
1.0 yd COM per single back

MODEL	COM	GR 1	GR 2	GR 3	GR 4	GR 5	GR 6
6201M	1090	1180	1211	1270	1361	1429	1520

Dimensions (inches)

seat H	18.0	seat W	21.0	arm H	25.0
total H	33.75	total W	25.25	depth	25.0

For KYDEX® flat arms add suffix K and \$274

Exceeds BIFMA Seating Durability Test to 500 lbs per chair
CAL 133, add \$120 List per chair



6201M
40 lbs



Pricing March 1, 2020
Discount 57.7% from List prices



MAS SIN 33721

COOPER COLLECTION - BALA Lounge Seating

Designed for today's healthcare facilities
Two and Three Seaters with outside arms

Standard Features

- Separate seat and back
- Wood components in Beech, in any of 9 standard stains or stain-to-match at no upcharge
- Threaded replaceable glides
- Use in connected layouts at no upcharge
- Velcro removable back covers
- Replaceable seats
- Arms replaceable in the field
- Ships assembled
- Ships 1/carton 26 cu ft (2 seater),
1/carton 39 cu ft (3 seater)

Options

- Wood or polyurethane arms available in flat (WF or PF) or rounded (WR or PR) profile
- Round polyurethane arms available in Black, Sterling Grey and Taupe (RAL 7006)
- Flat polyurethane arms available in Black only
- KYDEX® flat arms available in Black (B) or Taupe RAL 7006 (T) or Sterling Grey (G)
- Connected and freestanding tables
- Antibacterial and antimicrobial fabrics available
- Different fabric on seat and back at no upcharge
- CAL 133

Contact Spec Customer Service to railroad fabrics (specify repeat info and yardage requirement will be provided) and for repeats greater than 5" x 5"



Two Seater with outside arms

COM 3.5 yds
0.75 yd COM per single seat
1.0 yd COM per single back

MODEL	COM	GR 1	GR 2	GR 3	GR 4	GR 5	GR 6
6202M	1570	1750	1812	1931	2112	2251	2432

Dimensions (inches)
seat H 18.0 seat W 21.0 arm H 25.0
total H 33.75 total W 46.5 depth 25.0

For KYDEX® flat arms add suffix K and \$274
Exceeds BIFMA Seating Durability Test to 750 lbs per two seater
CAL 133, add \$240 List per two seater



6202M
66 lbs

Three Seater with outside arms

COM 5.25 yds
0.75 yd COM per single seat
1.0 yd COM per single back

MODEL	COM	GR 1	GR 2	GR 3	GR 4	GR 5	GR 6
6203M	2052	2325	2414	2597	2864	3072	3346

Dimensions (inches)
seat H 18.0 seat W 21.0 arm H 25.0
total H 33.75 total W 67.5 depth 25.0

For KYDEX® flat arms add suffix K and \$274
Exceeds BIFMA Seating Durability Test to 1000 lbs per three seater
CAL 133, add \$360 List per three seater



6203M
92 lbs



Pricing March 1, 2020
Discount 57.7% from List prices



MAS SIN 33721

COOPER COLLECTION - BALA Lounge Seating

Designed for today's healthcare facilities

Two and Three Seaters with half arms

Standard Features

- Separate seat and back
- Wood components in Beech, in any of 9 standard stains or stain-to-match at no upcharge
- Threaded replaceable glides
- Use in connected layouts at no upcharge
- Velcro removable back covers
- Replaceable seats
- Arms replaceable in the field
- Ships assembled
- Ships 1/carton 26 cu ft (2 seater), 1/carton 39 cu ft (3 seater)

Options

- Wood or polyurethane arms available in flat (WF or PF) or rounded (WR or PR) profile
- Round polyurethane arms available in Black, Sterling Grey and Taupe (RAL 7006)
- Flat polyurethane arms available in Black only
- KYDEX® flat arms available in Black (B) or Taupe RAL 7006 (T) or Sterling Grey (G)
- Connected and freestanding tables
- Antibacterial and antimicrobial fabrics available
- Different fabric on seat and back at no upcharge
- CAL 133

Contact Spec Customer Service to railroad fabrics (specify repeat info and yardage requirement will be provided) and for repeats greater than 5" x 5"



Two Seater with half arms

COM 3.5 yds
0.75 yd COM per single seat
1.0 yd COM per single back

MODEL	COM	GR 1	GR 2	GR 3	GR 4	GR 5	GR 6
6212M	2013	2194	2257	2377	2558	2693	2878

Dimensions (inches)
seat H 18.0 seat W 21.0 arm H 25.0
total H 33.75 total W 48.0 depth 25.0

For KYDEX® flat arms add suffix K and \$411
Exceeds BIFMA Seating Durability Test to 750 lbs per two seater
CAL 133, add \$240 List per two seater



6212M
68 lbs

Three Seater with half arms

COM 5.25 yds
0.75 yd COM per single seat
1.0 yd COM per single back

MODEL	COM	GR 1	GR 2	GR 3	GR 4	GR 5	GR 6
6213M	2940	3214	3304	3484	3755	3961	4233

Dimensions (inches)
seat H 18.0 seat W 21.0 arm H 25.0
total H 33.75 total W 70.5 depth 25.0

For KYDEX® flat arms add suffix K and \$548
Exceeds BIFMA Seating Durability Test to 1000 lbs per three seater
CAL 133, add \$360 List per three seater



6213M
96 lbs



Pricing March 1, 2020
Discount 57.7% from List prices



MAS SIN 33721

COOPER COLLECTION - BALA Lounge Seating

Designed for today's healthcare facilities

Two and Three Seaters with full arms

Standard Features

- Separate seat and back
- Wood components in Beech, in any of 9 standard stains or stain-to-match at no upcharge
- Threaded replaceable glides
- Use in connected layouts at no upcharge
- Velcro removable back covers
- Replaceable seats
- Arms replaceable in the field
- Ships assembled
- Ships 1/carton 26 cu ft (2 seater),
1/carton 39 cu ft (3 seater)

Options

- Wood or polyurethane arms available in flat (WF or PF) or rounded (WR or PR) profile
- Round polyurethane arms available in Black, Sterling Grey and Taupe (RAL 7006)
- Flat polyurethane arms available in Black only
- KYDEX® flat arms available in Black (B) or Taupe RAL 7006 (T) or Sterling Grey (G)
- Connected and freestanding tables
- Antibacterial and antimicrobial fabrics available
- Different fabric on seat and back at no upcharge
- CAL 133

Contact Spec Customer Service to railroad fabrics (specify repeat info and yardage requirement will be provided) and for repeats greater than 5" x 5"



Two Seater with full arms

COM 3.5 yds
0.75 yd COM per single seat
1.0 yd COM per single back

MODEL	COM	GR 1	GR 2	GR 3	GR 4	GR 5	GR 6
6222M	2013	2194	2257	2377	2558	2693	2878

Dimensions (inches)
seat H 18.0 seat W 21.0 arm H 25.0
total H 33.75 total W 48.0 depth 25.0

For KYDEX® flat arms add suffix K and \$411
Exceeds BIFMA Seating Durability Test to 750 lbs per two seater
CAL 133, add \$240 List per two seater



6222M
73 lbs

Three Seater with full arms

COM 5.25 yds
0.75 yd COM per single seat
1.0 yd COM per single back

MODEL	COM	GR 1	GR 2	GR 3	GR 4	GR 5	GR 6
6223M	2940	3214	3304	3484	3755	3961	4233

Dimensions (inches)
seat H 18.0 seat W 21.0 arm H 25.0
total H 33.75 total W 70.5 depth 25.0

For KYDEX® flat arms add suffix K and \$548
Exceeds BIFMA Seating Durability Test to 1000 lbs per three seater
CAL 133, add \$360 List per three seater



6223M
99 lbs



Pricing March 1, 2020
Discount 57.7% from List prices



MAS SIN 33721

COOPER COLLECTION - BALA Lounge Seating

Designed for today's healthcare facilities

Loveseat with arms

Standard Features

- Separate seat and back
- Wood components in Beech, in any of 9 standard stains or stain-to-match at no upcharge
- Threaded replaceable glides
- Use in connected layouts at no upcharge
- Velcro removable back covers
- Replaceable seats
- Arms replaceable in the field
- Ships assembled
- Ships 1/carton 20 cu ft

Options

- Wood or polyurethane arms available in flat (WF or PF) or rounded (WR or PR) profile
- Round polyurethane arms available in Black, Sterling Grey and Taupe (RAL 7006)
- Flat polyurethane arms available in Black only
- KYDEX® flat arms available in Black (B) or Taupe RAL 7006 (T) or Sterling Grey (G)
- Connected and freestanding tables
- Antibacterial and antimicrobial fabrics available
- Different fabric on seat and back at no upcharge
- CAL 133

Contact Spec Customer Service to railroad fabrics (specify repeat info and yardage requirement will be provided) and for repeats greater than 5" x 5"



Loveseat with arms

COM 4.0 yds
2.0 yd COM per single seat
2.0 yd COM per single back

MODEL	COM	GR 1	GR 2	GR 3	GR 4	GR 5	GR 6
6201L	1700	1909	1979	2123	2330	2493	2706

Dimensions (inches)

seat H	18.0	seat W	42.0	arm H	25.0
total H	33.75	total W	44.75	depth	25.0

For KYDEX® flat arms add suffix K and \$274

Exceeds BIFMA Seating Durability Test to 750 lbs per chair
CAL 133, add \$184 List per chair



6201L
66 lbs



Pricing March 1, 2020
Discount 57.7% from List prices



MAS SIN 33721

COOPER COLLECTION - BALA Lounge Seating

Designed for today's healthcare facilities
Bariatric Single Seater with arms

Standard Features

- Separate seat and back
- Wood components in Beech, in any of 9 standard stains or stain-to-match at no upcharge
- Threaded replaceable glides
- Use in connected layouts at no upcharge
- Velcro removable back covers
- Replaceable seats
- Arms replaceable in the field
- Ships assembled
- Ships 1/carton 20 cu ft

Contact Spec Customer Service to railroad fabrics (specify repeat info and yardage requirement will be provided) and for repeats greater than 5" x 5"

Options

- Wood or polyurethane arms available in flat (WF or PF) or rounded (WR or PR) profile
- Round polyurethane arms available in Black, Sterling Grey and Taupe (RAL 7006)
- Flat polyurethane arms available in Black only
- KYDEX® flat arms available in Black (B) or Taupe RAL 7006 (T) or Sterling Grey (G)
- Connected and freestanding tables
- Antibacterial and antimicrobial fabrics available
- Different fabric on seat and back at no upcharge
- CAL 133



Bariatric Single Seater with arms

COM 3.0 yds
1.5 yd COM per single seat
1.5 yd COM per single back

MODEL	COM	GR 1	GR 2	GR 3	GR 4	GR 5	GR 6
6201G	1296	1477	1537	1657	1838	1975	2155

Dimensions (inches)

seat H	18.0	seat W	30.0	arm H	25.0
total H	33.75	total W	34.25	depth	25.0

For KYDEX® flat arms add suffix K and \$274
Exceeds BIFMA Seating Durability Test to 750 lbs per chair
CAL 133, add \$150 List per chair



6201G
47 lbs



Pricing March 1, 2020
Discount 57.7% from List prices



MAS SIN 33721

COOPER COLLECTION - BALA Lounge Seating

Designed for today's healthcare facilities
Highback Single Seater with arms – Ottoman

Standard Features

- Separate seat and back
- Wood components in Beech, in any of 9 standard stains or stain-to-match at no upcharge
- Threaded replaceable glides
- Use in connected layouts at no upcharge
- Velcro removable back covers
- Replaceable seats
- Arms replaceable in the field
- Ships assembled
- Ships 1/carton 19 cu ft
- Ottoman ships 1/carton 5 cu ft

Options

- Wood or polyurethane arms available in flat (WF or PF) or rounded (WR or PR) profile
- Round polyurethane arms available in Black, Sterling Grey and Taupe (RAL 7006)
- Flat polyurethane arms available in Black only
- KYDEX® flat arms available in Black (B) or Taupe RAL 7006 (T) or Sterling Grey (G)
- Vinyl insert on top of the back, add \$44 List/seat back
- Connected and freestanding tables
- Antibacterial and antimicrobial fabrics available
- Different fabric on seat and back at no upcharge
- CAL 133

Contact Spec Customer Service to railroad fabrics (specify repeat info and yardage requirement will be provided) and for repeats greater than 5" x 5"



Highback Single Seater with arms

COM 2.5 yds
0.75 yd COM per single seat
1.75 yds COM per single back

MODEL	COM	GR 1	GR 2	GR 3	GR 4	GR 5	GR 6
6201H	1166	1306	1354	1451	1591	1700	1879

Dimensions (inches)

	seat H	18.0	seat W	21.0	arm H	25.0
total H	47.5	total W	25.25	depth	25.0	

For KYDEX® flat arms add suffix K and \$274
Exceeds BIFMA Seating Durability Test to 500 lbs per chair
CAL 133, add \$134 List per chair



6201H
43 lbs

Ottoman

0.5 yd COM per ottoman

MODEL	COM	GR 1	GR 2	GR 3	GR 4	GR 5	GR 6
6230F	494	527	541	563	601	626	675

Ottoman Dimensions (inches)

H	11.5	W	19.25	depth	12.25
---	------	---	-------	-------	-------

CAL 133, add \$55 List



6230F
16 lbs



Pricing March 1, 2020
Discount 57.7% from List prices



MAS SIN 33721

COOPER COLLECTION - BALA Lounge Seating

Designed for today's healthcare facilities
Half and Full Panel Arms

Options

To order half panel arms, add Z to model number,
e.g. 6201**Z**

- Antibacterial and antimicrobial fabrics available
- CAL 133

To order full panel arms, add ZC to model number,
e.g. 6201**ZC**

Pricing is for one half panel arm, e.g. for a single seater chair with half panel arms, add two half panel arms to cost of chair

Contact Spec Customer Service to railroad fabrics (specify repeat info and yardage requirement will be provided) and for repeats greater than 5" x 5"



Half and Full Panel Arms

COM 0.5 yds per half panel arm

MODEL	COM	GR 1	GR 2	GR 3	GR 4	GR 5	GR 6
Z	77	102	108	124	149	166	193

COM 0.75 yds per full panel arm

MODEL	COM	GR 1	GR 2	GR 3	GR 4	GR 5	GR 6
ZC	147	191	207	236	282	318	348

CAL 133, add \$42 List per half panel arm / \$80 List per full panel arm



1.5 lbs per half panel arm



3 lbs per full panel arm



Pricing March 1, 2020
Discount 57.7% from List prices



MAS SIN 33721

COOPER COLLECTION - BALA Lounge Seating

Designed for today's healthcare facilities
Easy Access Hip Single Seater with arms

Standard Features

- Separate seat and back
- Wood components in Beech, in any of 9 standard stains or stain-to-match at no upcharge
- Threaded replaceable glides
- 24" seat height, no seat pitch (level)
- Footrest which assists entering/exiting chair
- Velcro replaceable back covers
- Replaceable seats
- Arms replaceable in the field
- Ships assembled
- Ships 1/carton 19 cu ft

Options

- Wood or polyurethane arms available in flat (WF or PF) or rounded (WR or PR) profile
- Round polyurethane arms available in Black, Sterling Grey and Taupe (RAL 7006)
- Flat polyurethane arms available in Black only
- KYDEX® flat arms available in Black (B) or Taupe RAL 7006 (T) or Sterling Grey (G)
- Antibacterial and antimicrobial fabrics available
- Different fabric on seat and back at no upcharge
- CAL 133

Contact Spec Customer Service to railroad fabrics (specify repeat info and yardage requirement will be provided) and for repeats greater than 5" x 5"



Easy Access Hip Single Seater with arms

COM 1.75 yds
0.75 yd COM per single seat
1.0 yd COM per single back

MODEL	COM	GR 1	GR 2	GR 3	GR 4	GR 5	GR 6
6201ME	1314	1404	1433	1493	1584	1652	1744

Dimensions (inches)

seat H	24.0	seat W	21.0	arm H	32.0
total H	46.0	total W	25.25	depth	25.0

For KYDEX® flat arms add suffix K and \$274
Exceeds BIFMA Seating Durability Test to 500 lbs per chair
CAL 133, add \$120 List per chair



6201ME
45 lbs



Pricing March 1, 2020
Discount 57.7% from List prices



MAS SIN 33721

COOPER COLLECTION - BALA Lounge Seating

Designed for today's healthcare facilities
Single and Two Seater Benches

Standard Features

- Wood components in Beech, in any of 9 standard stains or stain-to-match at no upcharge
- Threaded replaceable glides
- Use in connected layouts at no upcharge
- Velcro removable back covers
- Replaceable seats
- Arms replaceable in the field
- Ships assembled
- Ships 1/carton 9 cu ft (single seater), 14 cu ft (2 seater), 21 cu ft (3 seater)

Options

- Antibacterial and antimicrobial fabrics available
- CAL 133

Contact Spec Customer Service to railroad fabrics (specify repeat info and yardage requirement will be provided) and for repeats greater than 5" x 5"

Single Seater Bench

COM 1.0 yds
1.0 yd COM per single seat

MODEL	COM	GR 1	GR 2	GR 3	GR 4	GR 5	GR 6
6201B	855	912	932	971	1032	1076	1159
<i>No arms</i>							

6201B	1093	1152	1172	1212	1270	1318	1404
<i>End arms (WF/WR or PF/PR)</i>							

Dimensions (inches)							
seat H	18.0	seat W	21.0	arm H	24.0	depth	26.25
total H	N/A	total W	24.25	total W	25.25		
		w/o arms		w/end arms			

Exceeds BIFMA Seating Durability Test to 500 lbs per bench
CAL 133, add \$55 List per bench



6201B
25 lbs

Two Seater Bench

COM 2.0 yds
1.0 yd COM per single seat

MODEL	COM	GR 1	GR 2	GR 3	GR 4	GR 5	GR 6
6202B	1111	1229	1267	1348	1466	1555	1709
<i>No arms</i>							

6202B	1351	1468	1509	1586	1706	1795	1953
<i>End arms (WF/WR or PF/PR)</i>							

6212B	1695	1815	1854	1932	2051	2140	2307
<i>Arms between and at ends (WF/WR or PF/PR)</i>							

Dimensions (inches)							
seat H	18.0	seat W	21.0	arm H	24.0	depth	26.25
total H	N/A	total W	45.25	total W	46.25	total W	47.75
		w/o arms		w/end arms		w/arms between and at ends	

Exceeds BIFMA Seating Durability Test to 750 lbs per two seat bench
CAL 133, add \$110 List per two seat bench



6202B
41 lbs



Pricing March 1, 2020
Discount 57.7% from List prices



MAS SIN 33721

COOPER COLLECTION - BALA Lounge Seating

Designed for today's healthcare facilities
Three Seater Bench

Standard Features

- Wood components in Beech, in any of 9 standard stains or stain-to-match at no upcharge
- Use in connected layouts at no upcharge
- Threaded replaceable glides
- Velcro removable back covers
- Replaceable seats
- Arms replaceable in the field
- Ships assembled
- Ships 1/carton 9 cu ft (single seater), 14 cu ft (2 seater), 21 cu ft (3 seater)

Options

- Antibacterial and antimicrobial fabrics available
- CAL 133

Contact Spec Customer Service to railroad fabrics (specify repeat info and yardage requirement will be provided) and for repeats greater than 5" x 5"



Three Seater Bench

COM 3.0 yds
1.0 yd COM per single seat

MODEL	COM	GR 1	GR 2	GR 3	GR 4	GR 5	GR 6
6203B	1432	1609	1669	1787	1965	2100	2325
<i>No arms</i>							
6203B	1669	1846	1905	2025	2203	2335	2566
<i>End arms (WF/WR or PF/PR)</i>							
6213B	2422	2601	2659	2777	2954	3090	3334
<i>Arms between and at ends (WF/WR or PF/PR)</i>							

Dimensions (inches)

seat H	18.0	seat W	21.0	arm H	24.0	depth	26.25
total H	N/A	total W	66.25	total W	67.25	total W	70.50
		w/o arms		w/end arms		w/arms between and at ends	

Exceeds BIFMA Seating Durability Test to 1000 lbs per three seat bench
CAL 133, add \$165 List per three seat bench



6203B
56 lbs





Pricing March 1, 2020
Discount 57.7% from List prices



MAS SIN 33721

COOPER COLLECTION - BALA Lounge Seating

Designed for today's healthcare facilities
Bariatric Single and Two Seater Benches

Standard Features

- Wood components in Beech, in any of 9 standard stains or stain-to-match at no upcharge
- Bariatric seating cannot connect to bariatric seating
- Threaded replaceable glides
- Use in connected layouts at no upcharge
- Velcro removable back covers
- Replaceable seats
- Arms replaceable in the field
- Ships assembled
- Ships 1/carton 15 cu ft (single seater), 20 cu ft (2 seater)

Options

- Wood or polyurethane arms, in flat (WF or PF) or rounded (WR or PR) profile, 6" in height, at ends of bench and between seats
- Round polyurethane arms available in Black, Sterling Grey and Taupe (RAL 7006)
- Flat polyurethane arms available in Black only
- KYDEX® flat arms available in Black (B) or Taupe RAL 7006 (T) or Sterling Grey (G)
- Antibacterial and antimicrobial fabrics available
- CAL 133

Contact Spec Customer Service to railroad fabrics (specify repeat info and yardage requirement will be provided) and for repeats greater than 5" x 5"



Bariatric Single Seater Bench

COM 1.5 yds
1.5 yd COM per single seat

MODEL	COM	GR 1	GR 2	GR 3	GR 4	GR 5	GR 6
6201BG	1259	1325	1349	1394	1462	1514	1614

End arms (WF/WR or PF/PR)

Dimensions (inches)

	seat H	18.0	seat W	30.0	arm H	24.0	depth	26.25
total H	24.0	total W	34.25					

For KYDEX® flat arms add suffix K and \$274
Exceeds BIFMA Seating Durability Test to 750 lbs per bench
CAL 133, add \$76 List per bench



6201BG
35 lbs

Bariatric Two Seater Bench

COM 3.0 yds
1.5 yd COM per single seat

MODEL	COM	GR 1	GR 2	GR 3	GR 4	GR 5	GR 6
6222BG	1952	2086	2132	2224	2359	2463	2654

Arms between and at ends (WF/WR or PF/PR)

Dimensions (inches)

	seat H	18.0	seat W	30.0	arm H	24.0	depth	26.25
total H	24.0	total W	66.0					

For KYDEX® flat arms add suffix K and \$411
Exceeds BIFMA Seating Durability Test to 1000 lbs per two seat bench
CAL 133, add \$152 List per two seat bench



6222BG
50 lbs



Pricing March 1, 2020
Discount 57.7% from List prices

spec™

MAS SIN 33721

COOPER COLLECTION - BALA Lounge Seating

Designed for today's healthcare facilities

Freestanding Lounge Tables – Corner and Spacer Connecting Tables

Standard Features

- Tops in laminate or veneer
- Select laminate tops from 15 standard laminates or choose any standard Wilsonart, Nevamar, Formica, Arborite and Pionite matte finish laminates at no upcharge.
- Freestanding lounge tables available with PVC Flat (PVF), 2mm (2MM), exposed Baltic Birch plywood (PF, PKNR) or hardwood (HB) edge
- Connecting table tops available with PVC Flat (PVF) edge, Self edge (SE) or hardwood (HB) edge
- 9 standard veneer and hardwood edge stains. Stain-to-match available at no upcharge.
- Beech legs and Beech table skirts stained the same
- Tops utilize NU Green earth friendly core
- Threaded replaceable glides
- 18" height

Options

- Non-standard laminates, contact Spec for pricing
- Custom size spacer tables for restricted spaces
- Other sizes may be available

Radius Corner Tables are recommended for open areas

Freestanding Lounge Tables

Model	Laminate PVF/SE/2MM	Laminate PF/PKNR/HB	Veneer HB	Weight	Cu.Ft.
62 - 24 x 24 SQ	813	1008	1163	47	7.2
62 - 24 x 48 RE	974	1189	1406	64	18
62 - 30 x 30 SQ	920	1062	1227	57	13.5
62 - 22 DIA	968	1328	1533	47	7.2



Corner and Spacer Connecting Tables

Model	Laminate PVF/SE	Laminate HB Edge	Veneer HB Edge	Weight	Cu.Ft.
62RC - 28 x 28 <i>Radius Corner Table</i>	832	1116	1308	42	2
62SC - 28 x 28 <i>Square Corner Table</i>	909	1104	1218	46	2
62TC - 45 degree <i>Corner Table</i>	832	1116	1308	40	2
62ST - 21 x 24 <i>Spacer Table</i>	565	797	913	27	2
62ET - 21 x 24 <i>End Table</i>	754	986	1103	37	2

