

TAILGATE TABLES



PRODUCT CODE



Series	Top Size	Top Shape	Series	Base	Finish
Tailgate Freestanding	Width x Length	B : Bullet RE : Rectangle RT : Racetrack BT : Boatshape REA : Rectangle Arc Ends	BTA : Boatshape Arc Ends EL : Ellipse VC : Video Conference VCA : Video Conference Arc Ends	Tailgate Freestanding	RE : Rectangle Plinth SQ : Square Plinth MNT2 : Manhattan Rect Double Column MRT2 : Manhattan Round Double Column
					L : Laminate V : Veneer

OPTIONS

BASES



Manhattan Round Double Column Manhattan Rectangular Double Column Plinth Base

VERTICAL WIRE MANAGER



Oval Vertical Wire Manager, with hinge door (shown on both columns) Rectangular Vertical Wire Manager, with removable door (shown on both columns)

FINISHES

LAMINATE

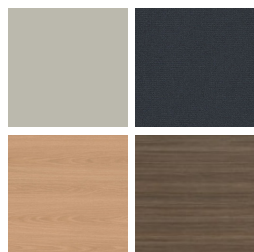

Select from 15 standard laminates or choose any standard Wilsonart, Nevamar, Formica, Arborite and Pionite matte finish laminates at no upcharge

VENEER



Select from one of our 9 standard wood stains or stain-to-match at no upcharge

BASE



Select from one of our 76 standard Spectone colors

EDGE



2MM PVF Hard Wood SE

See Spectone Card or specfurniture.com/materials/finishes for a complete list of finish options and colors.

TAILGATE TABLES

HOW TO ORDER



Specify Series, Top Size (Width x Length) and Shape

- A** Specify Top Type and Finish
For Laminate Top: Manufacturer, Laminate Name, Laminate Code
For Veneer Top: Wood Stain
- B** Specify Edge Type, (for hardwood: Style), and Finish
PVC Flat/2mm Bio/2mm PVC Woodgrain/Self Edge/Hardwood
- C** Specify Base Style and Finish
For Laminate Base: Manufacturer, Laminate Name, Laminate Code
For Veneer Base: Wood Stain
For Metal Base: RAL Finish
 Optional: Vertical Wire Managers, Power and Data Modules

Series, Top Size and Shape	Top Finish	Edge Finish	Base Style and Finish	VWM Finish (if applicable)	Trough Size and Finish
TG, 55 x 66, Rectangle	Laminate, Arborite, Brown Sugar	Hardwood, HF, Custom Brown Sugar Stain	TGRE-L, Veneer, Arborite, Brown Sugar	n/a	40", Silver

TABLE TOPS

On one-piece tabletops, grain direction runs lengthwise. On tabletops of two or more pieces, grain direction runs from side-to-side, as standard.

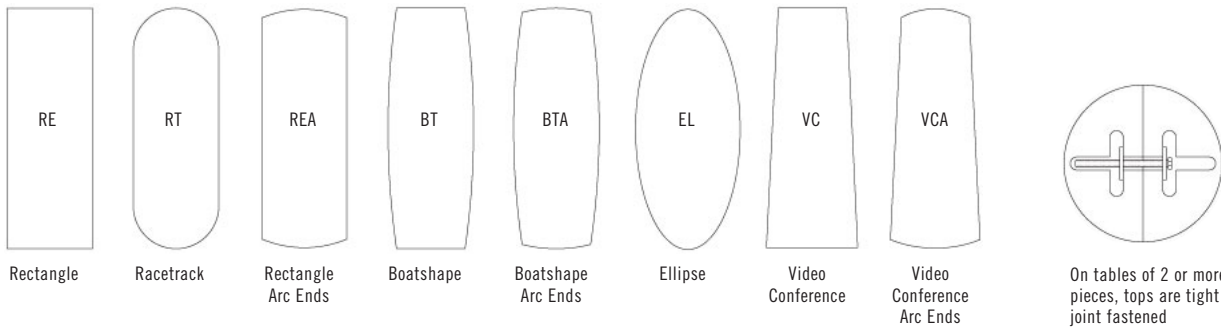

EDGE PROFILES

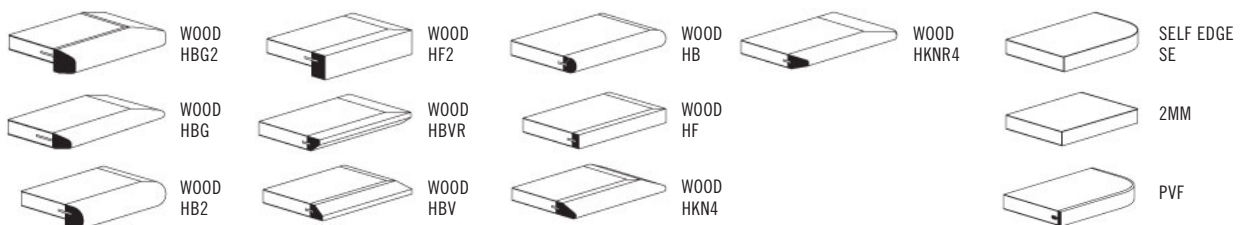



TAILGATE TABLES

TABLETOP



SIZE	TABLETOPS		TOP AND EDGE SPECIFICATIONS						TROUGHS		BASES		SEATS	LBS	
	Model	Number of Sections	SE PVF 2MM	HF HB	HBV HBVR HBG	HF2 HB2 HKN4 HKNR4 HBG2	For Veneer Top HF HB HB2	HF HB HB2	HBV HKN4 HKNR4 HBG2	Number of Troughs	Length of Trough(s)	Number of Bases Required	TGRE TGMNT2	TGSQ	Number of Seats
<i>Bullet</i>															
48 x 66	TG4866B	1	1793	2370	2545	2846	2920	3369	1	40	2	2		4	92
48 x 72	TG4872B	1	1885	2511	2702	3029	3111	3601	1	40	2	2		4	101
48 x 84	TG4884B	1	2260	2991	3214	3594	3690	4261	1	52	2	2		6	118
48 x 96	TG4896B	1	2437	3273	3527	3962	4071	4725	1	52	2	2		8	134
60 x 66	TG6066B	1	1939	2597	2798	3140	3226	3741	1	40	2	2		4	116
60 x 72	TG6072B	1	2039	2757	2976	3351	3444	4006	1	40	2	2		4	126
60 x 84	TG6084B	1	2440	3278	3533	3970	4079	4734	1	52	2	2		6	147
60 x 96	TG6096B	1	2643	3600	3892	4391	4516	5265	1	52	2	2		8	168

Price of top includes troughs and power duplexes. Number of duplexes varies depending on trough size and number of troughs per table. Trough door opens and closes from either side. An open perimeter around each side of the trough door allows the door to be closed while laptops and other items are plugged in.



BASES

MODEL	BASE SHAPE	LIST PRICE	LBS
TGRE-L	Rectangle Plinth, 11" x 22" - Laminate	796	60
TGRE-V	Rectangle Plinth, 11" x 22" - Veneer	940	60
TGSQ-L	Square Plinth, 22" x 22" - Laminate	796	70
TGSQ-V	Square Plinth, 22" x 22" - Veneer	940	70
TGMNT2	Manhattan Round Double Column	296	22
TGMRT2	Manhattan Rectangular Double Column	324	22
TGMNT2-VWM	Manhattan Round Double Column with 1 Oval Vertical Wire Manager	436	27
TGMNT2-RVWM	Manhattan Round Double Column with 1 Rectangular Vertical Wire Manager	436	27
TGMNT2-VWM2	Manhattan Round Double Column with 2 Oval Vertical Wire Managers	575	32
TGMNT2-RVWM2	Manhattan Round Double Column with 2 Rectangular Vertical Wire Managers	575	32



TGRE

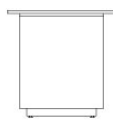

TGSQ

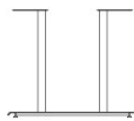

TGMNT2

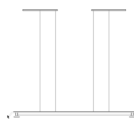

TGMRT2

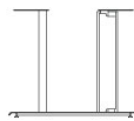

TGMNT2 WITH 1 VERTICAL WIRE MANAGER

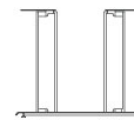

TGMNT2 WITH 2 VERTICAL WIRE MANAGERS

STANDARD FEATURES

- Select from 15 standard laminates or choose any standard Wilsonart, Nevamar, Formica, Arborite and Pionite matte finish laminates at no upcharge. For other laminate please contact the factory for pricing.
- 9 standard veneer and hardwood edge stains. Stain-to-match available at no upcharge.
- Standard with leveling glides.
- Plinth bases are standard with touch latch removable door.

- Plinth bases are standard with kickplate, finished in HOMAPAL 441 Brushed Natural Aluminum.
- Metal bases available in any Spectone color.
- Standard 29" table height.

OPTIONS

- For additional Power & Data modules, please see Table Accessories Price List.
- Cutout for wire pass-through at the bottom of Tailgate bases must be specified if required.

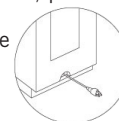

HOW TO ORDER

1. Select Top Size
2. Select Top Finish
3. Select Edge Style & Finish
4. Select Base
5. Select Base Finish

Example: 4896B - MNT2 -



TAILGATE TABLES

TABLETOP



SIZE	TABLETOPS		TOP AND EDGE SPECIFICATIONS						TROUGHS		BASES		SEATS	LBS
	Model	Number of Sections	SE PVF 2MM	HF HB	HBV HBVR HBG	HF2 HB2 HKN4 HBGR	For Veneer Top HF HB HB2 HKN4 HBVR HBG	HF2 HB2 HKN4 HBGR	Number of Troughs	Length of Trough(s)	Number of Bases Required	TGRE TGMNT2	TGSQ	Number of Seats
<i>Rectangle</i>														
48 x 96	TG4896RE	1	2074	2815	3017	3218	3523	4102	1	52	2	2	8	135
48 x 120	TG48120RE	2	2406	3365	3592	4082	4155	4832	1	76	3	2	10	168
48 x 144	TG48144RE	2	3192	4566	4867	5331	5221	6040	2	40	3	2	10	202
48 x 168	TG48168RE	2	3999	5383	5724	6376	6225	7176	2	52	3	3	12	236
48 x 192	TG48192RE	2	4264	6065	6481	7407	7090	8227	2	52	3	3	14	269
48 x 216	TG48216RE	2	4880	6664	7123	8108	7808	9089	2	76	3	3	14	303
60 x 120	TG60120RE	2	2801	4236	4548	5031	4917	5770	1	76	3	2	10	210
60 x 144	TG60144RE	2	3631	5351	5725	6306	6169	7189	2	40	3	2	12	252
60 x 168	TG60168RE	2	4395	6400	6835	7513	7352	8543	2	52	3	3	12	294
60 x 192	TG60192RE	2	4907	7312	7835	8650	8457	9885	2	52	3	3	14	336
60 x 216	TG60216RE	2	5405	8112	8702	9615	9398	11008	2	76	3	3	16	378

Price of top includes troughs and power duplexes. Number of duplexes varies depending on trough size and number of troughs per table. Trough door opens and closes from either side. An open perimeter around each side of the trough door allows the door to be closed while laptops and other items are plugged in.

BASES

MODEL	BASE SHAPE	LIST PRICE	LBS
TGRE-L	Rectangle Plinth, 11" x 22" - Laminate	796	60
TGRE-V	Rectangle Plinth, 11" x 22" - Veneer	940	60
TGSQ-L	Square Plinth, 22" x 22" - Laminate	796	70
TGSQ-V	Square Plinth, 22" x 22" - Veneer	940	70
TGMNT2	Manhattan Round Double Column	296	22
TGMRT2	Manhattan Rectangular Double Column	324	22
TGMNT2-VWM	Manhattan Round Double Column with 1 Oval Vertical Wire Manager	436	27
TGMNT2-RVWM	Manhattan Round Double Column with 1 Rectangular Vertical Wire Manager	436	27
TGMNT2-VWM2	Manhattan Round Double Column with 2 Oval Vertical Wire Managers	575	32
TGMNT2-RVWM2	Manhattan Round Double Column with 2 Rectangular Vertical Wire Managers	575	32

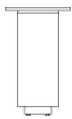

TGRE



TGSQ

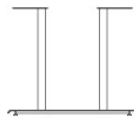

TGMNT2

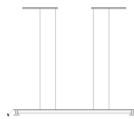

TGMRT2

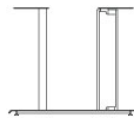

TGMNT2 WITH 1 VERTICAL WIRE MANAGER

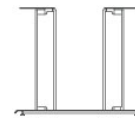

TGMNT2 WITH 2 VERTICAL WIRE MANAGERS

STANDARD FEATURES

- Select from 15 standard laminates or choose any standard Wilsonart, Nevamar, Formica, Arborite and Pionite matte finish laminates at no upcharge. For other laminate please contact the factory for pricing.
- 9 standard veneer and hardwood edge stains. Stain-to-match available at no upcharge.
- Standard with leveling glides.
- Plinth bases are standard with touch latch removable door.

- Plinth bases are standard with kickplate, finished in HOMAPAL 441 Brushed Natural Aluminum.
- Metal bases available in any Spectone color.
- Standard 29" table height.

OPTIONS

- For additional Power & Data modules, please see Table Accessories Price List.
- Cutout for wire pass-through at the bottom of Tailgate bases must be specified if required.

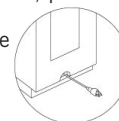

HOW TO ORDER

- Select Top Size
- Select Top Finish
- Select Edge Style & Finish
- Select Base
- Select Base Finish

Example: 4896RE - MNT2 -



TAILGATE TABLES

TABLETOP



SIZE	TABLETOPS		TOP AND EDGE SPECIFICATIONS						TROUGHS		BASES		SEATS	LBS
	Model	Number of Sections	SE PVF 2MM	HF HB	HBV HBVR HBG	HF2 HB2 HKN4 HKNR4 HBG2	For Veneer Top HF HB HBV HBVR HBG	HF2 HB2 HKN4 HKNR4 HBG2	Number of Troughs	Length of Trough(s)	Number of Bases Required	TGRE TGMNT2	TGSQ	Number of Seats
<i>Rectangle Arc Ends</i>														
48 x 96	TG4896REA	1	2089	2931	3134	3627	3973	4593	1	52	2	2	8	135
48 x 120	TG48120REA	2	2428	3759	4026	4705	4677	5401	1	76	3	2	10	168
48 x 144	TG48144REA	2	3218	4875	5204	6044	5849	6727	2	40	3	2	10	202
48 x 168	TG48168REA	2	4027	5830	6213	7145	6964	7982	2	52	3	3	12	236
48 x 192	TG48192REA	2	4179	6537	6988	7887	8129	8842	2	52	3	3	14	269
48 x 216	TG48216REA	2	4880	7220	7732	8846	9121	9815	2	76	3	3	14	303
60 x 120	TG60120REA	2	2793	4456	4788	5639	5602	6509	1	76	3	2	10	210
60 x 144	TG60144REA	2	3663	5735	6146	7199	6953	8049	2	40	3	2	12	252
60 x 168	TG60168REA	2	4576	6831	7309	8473	8247	9518	2	52	3	3	12	294
60 x 192	TG60192REA	2	5124	7832	8404	9801	10121	11057	2	52	3	3	14	336
60 x 216	TG60216REA	2	5651	8694	9339	10911	11272	12324	2	76	3	3	16	378

Price of top includes troughs and power duplexes. Number of duplexes varies depending on trough size and number of troughs per table. Trough door opens and closes from either side. An open perimeter around each side of the trough door allows the door to be closed while laptops and other items are plugged in.

BASES

MODEL	BASE SHAPE	LIST PRICE	LBS
TGRE-L	Rectangle Plinth, 11" x 22" - Laminate	796	60
TGRE-V	Rectangle Plinth, 11" x 22" - Veneer	940	60
TGSQ-L	Square Plinth, 22" x 22" - Laminate	796	70
TGSQ-V	Square Plinth, 22" x 22" - Veneer	940	70
TGMNT2	Manhattan Round Double Column	296	22
TGMRT2	Manhattan Rectangular Double Column	324	22
TGMNT2-VWM	Manhattan Round Double Column with 1 Oval Vertical Wire Manager	436	27
TGMNT2-RVWM	Manhattan Round Double Column with 1 Rectangular Vertical Wire Manager	436	27
TGMNT2-VWM2	Manhattan Round Double Column with 2 Oval Vertical Wire Managers	575	32
TGMNT2-RVWM2	Manhattan Round Double Column with 2 Rectangular Vertical Wire Managers	575	32



TGRE

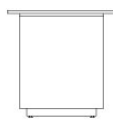

TGSQ

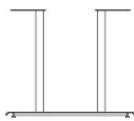

TGMNT2

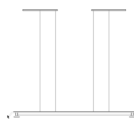

TGMRT2

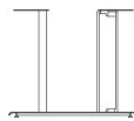

TGMNT2 WITH 1 VERTICAL WIRE MANAGER

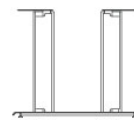

TGMNT2 WITH 2 VERTICAL WIRE MANAGERS

STANDARD FEATURES

- Select from 15 standard laminates or choose any standard Wilsonart, Nevamar, Formica, Arborite and Pionite matte finish laminates at no upcharge. For other laminate please contact the factory for pricing.
- 9 standard veneer and hardwood edge stains. Stain-to-match available at no upcharge.
- Standard with leveling glides.
- Plinth bases are standard with touch latch removable door.

- Plinth bases are standard with kickplate, finished in HOMAPAL 441 Brushed Natural Aluminum.
- Metal bases available in any Spectone color.
- Standard 29" table height.

OPTIONS

- For additional Power & Data modules, please see Table Accessories Price List.
- Cutout for wire pass-through at the bottom of Tailgate bases must be specified if required.

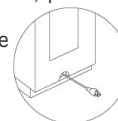

HOW TO ORDER

1. Select Top Size
2. Select Top Finish
3. Select Edge Style & Finish
4. Select Base
5. Select Base Finish

Example: 4896REA - MNT2 -





TAILGATE TABLES

TABLETOP



SIZE	TABLETOPS		TOP AND EDGE SPECIFICATIONS						TROUGHS		BASES		SEATS	LBS
	Model	Number of Sections	SE PVF 2MM	HF HB	HBV HBVR HBG	HF2 HB2 HKN4 HKNR4 HBG2	For Veneer Top HF HB HBV HBVR HBG	HF2 HB2 HKN4 HKNR4 HBG2	Number of Troughs	Length of Trough(s)	Number of Bases Required	TGRE TGMNT2	TGSQ	Number of Seats
<i>Racetrack</i>														
48 x 96	TG4896RT	1	2089	2931	3134	3627	3973	4593	1	52	2	2	8	135
48 x 120	TG48120RT	2	2428	3759	4026	4705	4677	5401	1	76	3	2	10	168
48 x 144	TG48144RT	2	3218	4875	5204	6044	5849	6727	2	40	3	2	10	202
48 x 168	TG48168RT	2	4027	5830	6213	7145	6964	7982	2	52	3	3	12	236
48 x 192	TG48192RT	2	4179	6537	6988	7887	8129	8842	2	52	3	3	14	269
48 x 216	TG48216RT	2	4880	7220	7732	8846	9121	9815	2	76	3	3	14	303
60 x 120	TG60120RT	2	2793	4456	4788	5639	5602	6509	1	76	3	2	10	210
60 x 144	TG60144RT	2	3663	5735	6146	7199	6953	8049	2	40	3	2	12	252
60 x 168	TG60168RT	2	4576	6831	7309	8473	8247	9518	2	52	3	3	12	294
60 x 192	TG60192RT	2	5124	7832	8404	9801	10121	11057	2	52	3	3	14	336
60 x 216	TG60216RT	2	5651	8694	9339	10911	11272	12324	2	76	3	3	16	378

Price of top includes troughs and power duplexes. Number of duplexes varies depending on trough size and number of troughs per table. Trough door opens and closes from either side. An open perimeter around each side of the trough door allows the door to be closed while laptops and other items are plugged in.

BASES

MODEL	BASE SHAPE	LIST PRICE	LBS
TGRE-L	Rectangle Plinth, 11" x 22" - Laminate	796	60
TGRE-V	Rectangle Plinth, 11" x 22" - Veneer	940	60
TGSQ-L	Square Plinth, 22" x 22" - Laminate	796	70
TGSQ-V	Square Plinth, 22" x 22" - Veneer	940	70
TGMNT2	Manhattan Round Double Column	296	22
TGMRT2	Manhattan Rectangular Double Column	324	22
TGMNT2-VWM	Manhattan Round Double Column with 1 Oval Vertical Wire Manager	436	27
TGMNT2-RVWM	Manhattan Round Double Column with 1 Rectangular Vertical Wire Manager	436	27
TGMNT2-VWM2	Manhattan Round Double Column with 2 Oval Vertical Wire Managers	575	32
TGMNT2-RVWM2	Manhattan Round Double Column with 2 Rectangular Vertical Wire Managers	575	32



TGRE

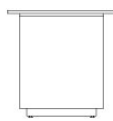

TGSQ

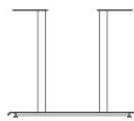

TGMNT2

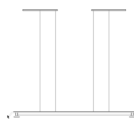

TGMRT2

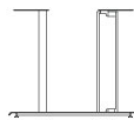

TGMNT2 WITH 1 VERTICAL WIRE MANAGER

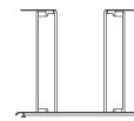

TGMNT2 WITH 2 VERTICAL WIRE MANAGERS

STANDARD FEATURES

- Select from 15 standard laminates or choose any standard Wilsonart, Nevamar, Formica, Arborite and Pionite matte finish laminates at no upcharge. For other laminate please contact the factory for pricing.
- 9 standard veneer and hardwood edge stains. Stain-to-match available at no upcharge.
- Standard with leveling glides.
- Plinth bases are standard with touch latch removable door.

- Plinth bases are standard with kickplate, finished in HOMAPAL 441 Brushed Natural Aluminum.
- Metal bases available in any Spectone color.
- Standard 29" table height.

OPTIONS

- For additional Power & Data modules, please see Table Accessories Price List.
- Cutout for wire pass-through at the bottom of Tailgate bases must be specified if required.

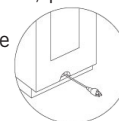

HOW TO ORDER

1. Select Top Size
2. Select Top Finish
3. Select Edge Style & Finish
4. Select Base
5. Select Base Finish

Example: 4896RT - MNT2 -



TAILGATE TABLES

TABLETOP

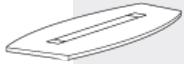

SIZE	TABLETOPS		TOP AND EDGE SPECIFICATIONS						TROUGHS		BASES		SEATS	LBS
	Model	Number of Sections	SE PVF 2MM	HF HB	HBV HBVR HBG	HF2 HB2 HKN4 HBGR4 HBG2	For Veneer Top HF HB HBV HBVR HBG	HF2 HB2 HKN4 HBGR4 HBG2	Number of Troughs	Length of Trough(s)	Number of Bases Required	TGRE TGMNT2	TGSQ	Number of Seats
<i>Boatshape</i>														
48 x 96	TG4896BT	1	2089	3500	3764	4036	4419	4757	1	52	2	2	8	135
48 x 120	TG48120BT	2	2428	4386	4714	5058	5204	5593	1	76	3	2	10	168
48 x 144	TG48144BT	2	3218	5502	5893	6306	6827	7179	2	40	3	2	10	202
48 x 168	TG48168BT	2	4027	6525	6977	7454	7696	8246	2	52	3	3	12	236
48 x 192	TG48192BT	2	4179	7243	7765	8796	9075	9894	2	52	3	3	14	269
48 x 216	TG48216BT	2	4880	8009	8599	9880	10197	10995	2	76	3	3	14	303
60 x 120	TG60120BT	2	2793	5239	5650	6078	6264	6748	1	76	3	2	10	210
60 x 144	TG60144BT	2	3663	6521	7007	7523	8173	8617	2	40	3	2	12	252
60 x 168	TG60168BT	2	4576	7698	8263	8860	9163	9850	2	52	3	3	12	294
60 x 192	TG60192BT	2	5124	8871	9550	10265	10626	11451	2	52	3	3	14	336
60 x 216	TG60216BT	2	5651	9867	10629	11434	11841	12768	2	76	3	3	16	378

Price of top includes troughs and power duplexes. Number of duplexes varies depending on trough size and number of troughs per table. Trough door opens and closes from either side. An open perimeter around each side of the trough door allows the door to be closed while laptops and other items are plugged in.

BASES

MODEL	BASE SHAPE	LIST PRICE	LBS
TGRE-L	Rectangle Plinth, 11" x 22" - Laminate	796	60
TGRE-V	Rectangle Plinth, 11" x 22" - Veneer	940	60
TGSQ-L	Square Plinth, 22" x 22" - Laminate	796	70
TGSQ-V	Square Plinth, 22" x 22" - Veneer	940	70
TGMNT2	Manhattan Round Double Column	296	22
TGMRT2	Manhattan Rectangular Double Column	324	22
TGMNT2-VWM	Manhattan Round Double Column with 1 Oval Vertical Wire Manager	436	27
TGMNT2-RVWM	Manhattan Round Double Column with 1 Rectangular Vertical Wire Manager	436	27
TGMNT2-VWM2	Manhattan Round Double Column with 2 Oval Vertical Wire Managers	575	32
TGMNT2-RVWM2	Manhattan Round Double Column with 2 Rectangular Vertical Wire Managers	575	32

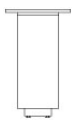

TGRE

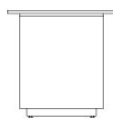

TGSQ

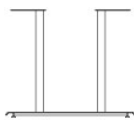

TGMNT2

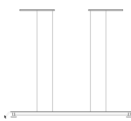

TGMRT2

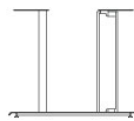

TGMNT2 WITH 1 VERTICAL WIRE MANAGER

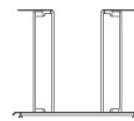

TGMNT2 WITH 2 VERTICAL WIRE MANAGERS

STANDARD FEATURES

- Select from 15 standard laminates or choose any standard Wilsonart, Nevamar, Formica, Arborite and Pionite matte finish laminates at no upcharge. For other laminate please contact the factory for pricing.
- 9 standard veneer and hardwood edge stains. Stain-to-match available at no upcharge.
- Standard with leveling glides.
- Plinth bases are standard with touch latch removable door.

- Plinth bases are standard with kickplate, finished in HOMAPAL 441 Brushed Natural Aluminum.
- Metal bases available in any Spectone color.
- Standard 29" table height.

OPTIONS

- For additional Power & Data modules, please see Table Accessories Price List.
- Cutout for wire pass-through at the bottom of Tailgate bases must be specified if required.

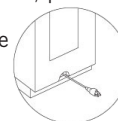

HOW TO ORDER

1. Select Top Size
2. Select Top Finish
3. Select Edge Style & Finish
4. Select Base
5. Select Base Finish

Example: 4896BT - MNT2 -



TAILGATE TABLES

TABLETOP



SIZE	TABLETOPS		TOP AND EDGE SPECIFICATIONS						TROUGHS		BASES		SEATS	LBS
	Model	Number of Sections	For Laminate Top			For Veneer Top			Number of Troughs	Length of Trough(s)	Number of Bases Required		Number of Seats	
SE PVF 2MM	HF HB	HBV HBVR HBG	HF2 HB2 HKN4 HBKNR4 HBG2	HF HB HBV HBVR HBG	HF2 HB2 HKN4 HBKNR4 HBG2	TGRE TGMNT2	TGSQ							
<i>Boatshape Arc Ends</i>														
48 x 96	TG4896BTA	1	2234	3955	4217	4489	4870	5210	1	52	2	2	8	135
48 x 120	TG48120BTA	2	2571	4840	5166	5509	5655	6045	1	76	3	2	10	168
48 x 144	TG48144BTA	2	3361	5955	6345	6756	7277	7632	2	40	3	2	10	202
48 x 168	TG48168BTA	2	4172	6977	7428	7906	8148	8699	2	52	3	3	12	236
48 x 192	TG48192BTA	2	4413	7782	8356	9492	9799	10700	2	52	3	3	14	269
48 x 216	TG48216BTA	2	5173	8618	9265	10674	11023	11899	2	76	3	3	14	303
60 x 120	TG60120BTA	2	2972	5806	6213	6644	6825	7311	1	76	3	2	10	210
60 x 144	TG60144BTA	2	3842	7085	7573	8089	8737	9180	2	40	3	2	12	252
60 x 168	TG60168BTA	2	4757	8263	8828	9423	9726	10414	2	52	3	3	12	294
60 x 192	TG60192BTA	2	5340	9550	10228	10939	11305	12130	2	52	3	3	14	336
60 x 216	TG60216BTA	2	5894	10629	11391	12195	12603	13532	2	76	3	3	16	378

Price of top includes troughs and power duplexes. Number of duplexes varies depending on trough size and number of troughs per table. Trough door opens and closes from either side. An open perimeter around each side of the trough door allows the door to be closed while laptops and other items are plugged in.

BASES

MODEL	BASE SHAPE	LIST PRICE	LBS
TGRE-L	Rectangle Plinth, 11" x 22" - Laminate	796	60
TGRE-V	Rectangle Plinth, 11" x 22" - Veneer	940	60
TGSQ-L	Square Plinth, 22" x 22" - Laminate	796	70
TGSQ-V	Square Plinth, 22" x 22" - Veneer	940	70
TGMNT2	Manhattan Round Double Column	296	22
TGMRT2	Manhattan Rectangular Double Column	324	22
TGMNT2-VWM	Manhattan Round Double Column with 1 Oval Vertical Wire Manager	436	27
TGMNT2-RVWM	Manhattan Round Double Column with 1 Rectangular Vertical Wire Manager	436	27
TGMNT2-VWM2	Manhattan Round Double Column with 2 Oval Vertical Wire Managers	575	32
TGMNT2-RVWM2	Manhattan Round Double Column with 2 Rectangular Vertical Wire Managers	575	32



TGRE

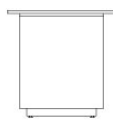

TGSQ

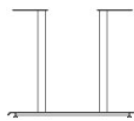

TGMNT2

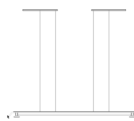

TGMRT2

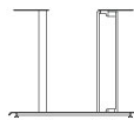

TGMNT2 WITH 1 VERTICAL WIRE MANAGER

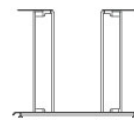

TGMNT2 WITH 2 VERTICAL WIRE MANAGERS

STANDARD FEATURES

- Select from 15 standard laminates or choose any standard Wilsonart, Nevamar, Formica, Arborite and Pionite matte finish laminates at no upcharge. For other laminate please contact the factory for pricing.
- 9 standard veneer and hardwood edge stains. Stain-to-match available at no upcharge.
- Standard with leveling glides.
- Plinth bases are standard with touch latch removable door.

- Plinth bases are standard with kickplate, finished in HOMAPAL 441 Brushed Natural Aluminum.
- Metal bases available in any Spectone color.
- Standard 29" table height.

OPTIONS

- For additional Power & Data modules, please see Table Accessories Price List.
- Cutout for wire pass-through at the bottom of Tailgate bases must be specified if required.



HOW TO ORDER

- Select Top Size
- Select Top Finish
- Select Edge Style & Finish
- Select Base
- Select Base Finish

Example: 4896BTA - MNT2 -

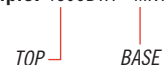

TAILGATE TABLES

TABLETOP



SIZE	TABLETOPS		TOP AND EDGE SPECIFICATIONS						TROUGHS		BASES		SEATS	LBS
	Model	Number of Sections	SE PVF 2MM	HF HB	HBV HBVR HBG	HF2 HB2 HKN4 HKNR4 HBG2	For Veneer Top HF HB HBV HBVR HBG	HF2 HB2 HKN4 HKNR4 HBG2	Number of Troughs	Length of Trough(s)	Number of Bases Required	TGRE TGMNT2	TGSQ	Number of Seats
<i>Ellipse</i>														
48 x 96	TG4896EL	1	2326	4018	4335	4661	5119	5525	1	52	2	2	8	135
48 x 120	TG48120EL	2	2719	5069	5462	5873	6052	6515	1	76	3	2	10	168
48 x 144	TG48144EL	2	3573	6317	6784	7280	7903	8330	2	40	3	2	10	202
48 x 168	TG48168EL	2	4467	7463	8006	8576	8847	9530	2	52	3	3	12	236
48 x 192	TG48192EL	2	4672	8379	9009	10256	10595	11586	2	52	3	3	14	269
48 x 216	TG48216EL	2	5496	9285	9995	11548	11932	12894	2	76	3	3	14	303
60 x 120	TG60120EL	2	3273	6533	6999	7494	7704	8261	1	76	3	2	10	210
60 x 144	TG60144EL	2	4203	7932	8493	9087	9832	10341	2	40	3	2	12	252
60 x 168	TG60168EL	2	5195	9227	9876	10561	10910	11701	2	52	3	3	12	294
60 x 192	TG60192EL	2	5868	10706	11487	12307	12725	13676	2	52	3	3	14	336
60 x 216	TG60216EL	2	6486	11931	12808	13731	14201	15271	2	76	3	3	16	378

Price of top includes troughs and power duplexes. Number of duplexes varies depending on trough size and number of troughs per table. Trough door opens and closes from either side. An open perimeter around each side of the trough door allows the door to be closed while laptops and other items are plugged in.

BASES

MODEL	BASE SHAPE	LIST PRICE	LBS
TGRE-L	Rectangle Plinth, 11" x 22" - Laminate	796	60
TGRE-V	Rectangle Plinth, 11" x 22" - Veneer	940	60
TGSQ-L	Square Plinth, 22" x 22" - Laminate	796	70
TGSQ-V	Square Plinth, 22" x 22" - Veneer	940	70
TGMNT2	Manhattan Round Double Column	296	22
TGMRT2	Manhattan Rectangular Double Column	324	22
TGMNT2-VWM	Manhattan Round Double Column with 1 Oval Vertical Wire Manager	436	27
TGMNT2-RVWM	Manhattan Round Double Column with 1 Rectangular Vertical Wire Manager	436	27
TGMNT2-VWM2	Manhattan Round Double Column with 2 Oval Vertical Wire Managers	575	32
TGMNT2-RVWM2	Manhattan Round Double Column with 2 Rectangular Vertical Wire Managers	575	32

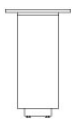

TGRE

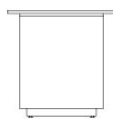

TGSQ

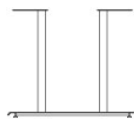

TGMNT2

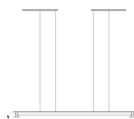

TGMRT2

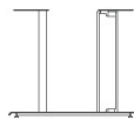

TGMNT2 WITH 1 VERTICAL WIRE MANAGER

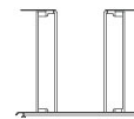

TGMNT2 WITH 2 VERTICAL WIRE MANAGERS

STANDARD FEATURES

- Select from 15 standard laminates or choose any standard Wilsonart, Nevamar, Formica, Arborite and Pionite matte finish laminates at no upcharge. For other laminate please contact the factory for pricing.
- 9 standard veneer and hardwood edge stains. Stain-to-match available at no upcharge.
- Standard with leveling glides.
- Plinth bases are standard with touch latch removable door.

- Plinth bases are standard with kickplate, finished in HOMAPAL 441 Brushed Natural Aluminum.
- Metal bases available in any Spectone color.
- Standard 29" table height.

OPTIONS

- For additional Power & Data modules, please see Table Accessories Price List.
- Cutout for wire pass-through at the bottom of Tailgate bases must be specified if required.



HOW TO ORDER

1. Select Top Size
2. Select Top Finish
3. Select Edge Style & Finish
4. Select Base
5. Select Base Finish

Example: 4896EL - MNT2 -





TAILGATE TABLES

TABLETOP

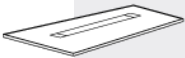

SIZE	TABLETOPS		TOP AND EDGE SPECIFICATIONS						TROUGHS		BASES		SEATS	LBS
	Model	Number of Sections	SE PVF 2MM	HF HB	HBV HBVR HBG	HF2 HB2 HKN4 HBGR4 HBG2	For Veneer Top HF HB HBV HBVR HBG	HF2 HB2 HKN4 HBGR4 HBG2	Number of Troughs	Length of Trough(s)	Number of Bases Required	TGRE TGMNT2	TGSQ	Number of Seats
<i>Video Conference</i>														
48 x 96	TG4896VC	1	2089	3500	3764	4036	4419	4757	1	52	2	2	8	135
48 x 120	TG48120VC	2	2428	4386	4714	5058	5204	5593	1	76	3	2	10	168
48 x 144	TG48144VC	2	3218	5502	5893	6306	6827	7179	2	40	3	2	10	202
48 x 168	TG48168VC	2	4027	6525	6977	7454	7678	8246	2	52	3	3	12	236
48 x 192	TG48192VC	2	4179	7243	7765	8796	9075	9894	2	52	3	3	14	269
48 x 216	TG48216VC	2	4880	8009	8599	9880	10197	10995	2	76	3	3	14	303
60 x 120	TG60120VC	2	2793	5239	5650	6078	6264	6748	1	76	3	2	10	210
60 x 144	TG60144VC	2	3663	6521	7007	7523	8173	8617	2	40	3	2	12	252
60 x 168	TG60168VC	2	4576	7698	8263	8860	9163	9850	2	52	3	3	12	294
60 x 192	TG60192VC	2	5124	8871	9550	10265	10626	11451	2	52	3	3	14	336
60 x 216	TG60216VC	2	5651	9867	10629	11434	11841	12768	2	76	3	3	16	378

Price of top includes troughs and power duplexes. Number of duplexes varies depending on trough size and number of troughs per table. Trough door opens and closes from either side. An open perimeter around each side of the trough door allows the door to be closed while laptops and other items are plugged in.

BASES

MODEL	BASE SHAPE	LIST PRICE	LBS
TGRE-L	Rectangle Plinth, 11" x 22" - Laminate	796	60
TGRE-V	Rectangle Plinth, 11" x 22" - Veneer	940	60
TGSQ-L	Square Plinth, 22" x 22" - Laminate	796	70
TGSQ-V	Square Plinth, 22" x 22" - Veneer	940	70
TGMNT2	Manhattan Round Double Column	296	22
TGMRT2	Manhattan Rectangular Double Column	324	22
TGMNT2-VWM	Manhattan Round Double Column with 1 Oval Vertical Wire Manager	436	27
TGMNT2-RVWM	Manhattan Round Double Column with 1 Rectangular Vertical Wire Manager	436	27
TGMNT2-VWM2	Manhattan Round Double Column with 2 Oval Vertical Wire Managers	575	32
TGMNT2-RVWM2	Manhattan Round Double Column with 2 Rectangular Vertical Wire Managers	575	32

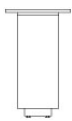

TGRE

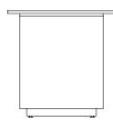

TGSQ

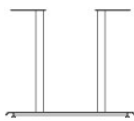

TGMNT2

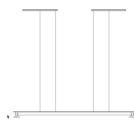

TGMRT2

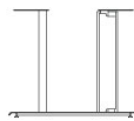

TGMNT2 WITH 1 VERTICAL WIRE MANAGER

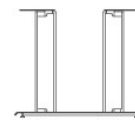

TGMNT2 WITH 2 VERTICAL WIRE MANAGERS

STANDARD FEATURES

- Select from 15 standard laminates or choose any standard Wilsonart, Nevamar, Formica, Arborite and Pionite matte finish laminates at no upcharge. For other laminate please contact the factory for pricing.
- 9 standard veneer and hardwood edge stains. Stain-to-match available at no upcharge.
- Standard with leveling glides.
- Plinth bases are standard with touch latch removable door.

- Plinth bases are standard with kickplate, finished in HOMAPAL 441 Brushed Natural Aluminum.
- Metal bases available in any Spectone color.
- Standard 29" table height.

OPTIONS

- For additional Power & Data modules, please see Table Accessories Price List.
- Cutout for wire pass-through at the bottom of Tailgate bases must be specified if required.

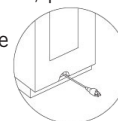

HOW TO ORDER

1. Select Top Size
2. Select Top Finish
3. Select Edge Style & Finish
4. Select Base
5. Select Base Finish

Example: 4896VC - MNT2 -



TAILGATE TABLES

TABLETOP

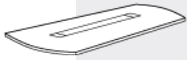

SIZE	TABLETOPS		TOP AND EDGE SPECIFICATIONS						TROUGHS		BASES		SEATS	LBS
	Model	Number of Sections	SE PVF 2MM	HF HB	HBV HBVR HBG	HF2 HB2 HKN4 HKNR4 HBG2	For Veneer Top HF HB HBV HBVR HBG	HF2 HB2 HKN4 HKNR4 HBG2	Number of Troughs	Length of Trough(s)	Number of Bases Required	TGRE TGMNT2	TGSQ	Number of Seats
<i>Video Conference Arc Ends</i>														
48 x 96	TG4896VCA	1	2234	3955	4217	4489	4870	5210	1	52	2	2	8	135
48 x 120	TG48120VCA	2	2571	4840	5166	5509	5655	6045	1	76	3	2	10	168
48 x 144	TG48144VCA	2	3361	5955	6345	6756	7277	7632	2	40	3	2	10	202
48 x 168	TG48168VCA	2	4172	6977	7428	7906	8148	8699	2	52	3	3	12	236
48 x 192	TG48192VCA	2	4413	7782	8356	9492	9799	10700	2	52	3	3	14	269
48 x 216	TG48216VCA	2	5173	8618	9265	10674	11023	11899	2	76	3	3	14	303
60 x 120	TG60120VCA	2	2972	5806	6213	6644	6825	7311	1	76	3	2	10	210
60 x 144	TG60144VCA	2	3842	7085	7573	8089	8737	9180	2	40	3	2	12	252
60 x 168	TG60168VCA	2	4757	8263	8828	9423	9726	10414	2	52	3	3	12	294
60 x 192	TG60192VCA	2	5340	9550	10228	10939	11305	12130	2	52	3	3	14	336
60 x 216	TG60216VCA	2	5894	10629	11391	12195	12603	13532	2	76	3	3	16	378

Price of top includes troughs and power duplexes. Number of duplexes varies depending on trough size and number of troughs per table. Trough door opens and closes from either side. An open perimeter around each side of the trough door allows the door to be closed while laptops and other items are plugged in.

BASES

MODEL	BASE SHAPE	LIST PRICE	LBS
TGRE-L	Rectangle Plinth, 11" x 22" - Laminate	796	60
TGRE-V	Rectangle Plinth, 11" x 22" - Veneer	940	60
TGSQ-L	Square Plinth, 22" x 22" - Laminate	796	70
TGSQ-V	Square Plinth, 22" x 22" - Veneer	940	70
TGMNT2	Manhattan Round Double Column	296	22
TGMRT2	Manhattan Rectangular Double Column	324	22
TGMNT2-VWM	Manhattan Round Double Column with 1 Oval Vertical Wire Manager	436	27
TGMNT2-RVWM	Manhattan Round Double Column with 1 Rectangular Vertical Wire Manager	436	27
TGMNT2-VWM2	Manhattan Round Double Column with 2 Oval Vertical Wire Managers	575	32
TGMNT2-RVWM2	Manhattan Round Double Column with 2 Rectangular Vertical Wire Managers	575	32



TGRE

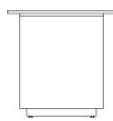

TGSQ

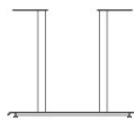

TGMNT2

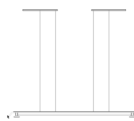

TGMRT2

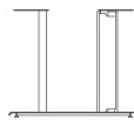

TGMNT2 WITH 1 VERTICAL WIRE MANAGER

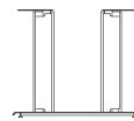

TGMNT2 WITH 2 VERTICAL WIRE MANAGERS

STANDARD FEATURES

- Select from 15 standard laminates or choose any standard Wilsonart, Nevamar, Formica, Arborite and Pionite matte finish laminates at no upcharge. For other laminate please contact the factory for pricing.
- 9 standard veneer and hardwood edge stains. Stain-to-match available at no upcharge.
- Standard with leveling glides.
- Plinth bases are standard with touch latch removable door.

- Plinth bases are standard with kickplate, finished in HOMAPAL 441 Brushed Natural Aluminum.
- Metal bases available in any Spectone color.
- Standard 29" table height.

OPTIONS

- For additional Power & Data modules, please see Table Accessories Price List.
- Cutout for wire pass-through at the bottom of Tailgate bases must be specified if required.

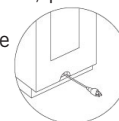

HOW TO ORDER

1. Select Top Size
2. Select Top Finish
3. Select Edge Style & Finish
4. Select Base
5. Select Base Finish

Example: 4896VCA - MNT2 -



TAILGATE TABLES

POWER AND VOICE/DATA ACCESSORIES

Power and Communication Trough is included in price.

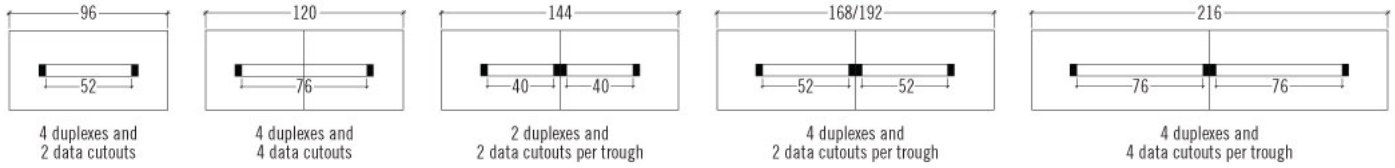

Each trough is standard with power duplexes (labelled P) with a 9 ft. cord. Cutouts for data and communication (labelled D) are also included, however, data ports must be specified separately and can be configured to meet specific requirements. Specify blank plates when data and communication is not required at no upcharge.

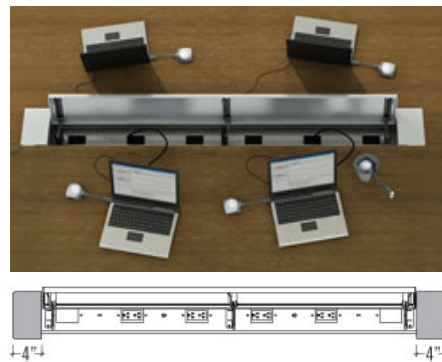
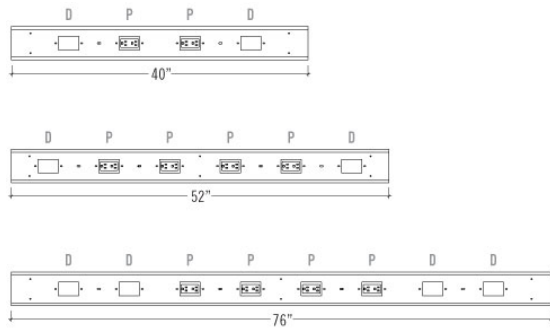

Trough end caps are always 4" long and 6.5" wide.

Units in data plates must equal 3. Plates can be made up of items that equal 1 unit each for a total of 3 units or a combination of items that total 3 units.

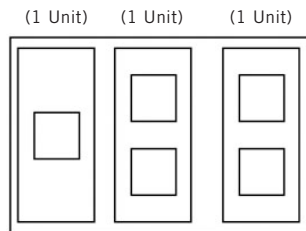

OPTION 11 - \$109 List
15 Pin VGA
(1 Unit)
Front: 15 Pin Female
Back: 15 Pin Female



OPTION 14 - No Charge
Blank
(1 Unit)



OPTION 33 - \$120
3.5mm Stereo (F/F)
(1 Unit)



OPTION 30 - \$54 List
RJ 11 (cat. 3)/
RJ 45 (cat. 6)
(1 Unit)



OPTION 17 - \$61 List
RJ 11 (cat. 3) X 2
(1 Unit)



OPTION 28 - \$45 List
RJ 45 (cat. 6) X 2
(1 Unit)



OPTION 19 - \$35 List
RJ 11 (cat. 3) X 1
(1 Unit)



OPTION 29 - \$25 List
RJ 45 (cat. 6) X 1
(1 Unit)



OPTION 21 - \$267 List
USB 2.0 Performance
(1 Unit)
Front: Type A & B (F/F)
Back: Type A & B (F/F)



OPTION 22 - \$140 List
USB 2.0 Performance
(1 Unit)
Front: Type A & A (F/F)
Back: Type A & A (F/F)



OPTION 23 - \$345 List
HDMI-A/V Connector
(1 Unit)
Front: Female
Back: Female



OPTION 32 - \$167 List
RJ 45 (cat. 6)
USB 2.0 (F/F) Type A & A
(1 Unit)

TAILGATE TABLES

VOICE/DATA ACCESSORIES

Examples of 1 Data Plate

PLATE CONFIGURATION OPTIONS FOR DATA & PHONE

6X RJ 45 (CAT. 6)

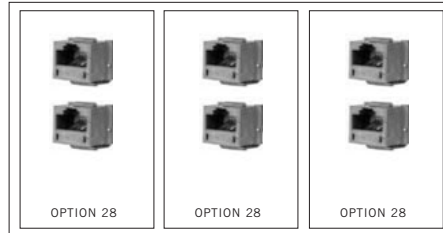

CONFIGURATION A

Consists of the following:

3x **OPTION 28** = \$45 LIST

TOTAL LIST = \$135 LIST

1X RJ 11 (CAT. 3), AND 5X RJ 45 (CAT. 6)

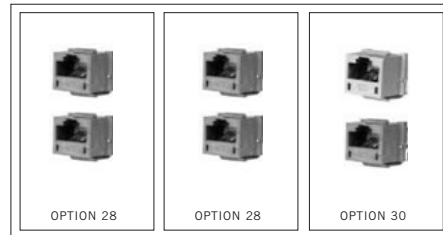

CONFIGURATION B

Consists of the following:

1x **OPTION 30** = \$54 LIST

2x **OPTION 28** = \$45 LIST

TOTAL LIST = \$144 LIST



PLATE CONFIGURATION OPTIONS FOR AUDIO/VIDEO

1X 15 PIN VGA, BLANK AND RJ 11, RJ 45 (CAT. 6)

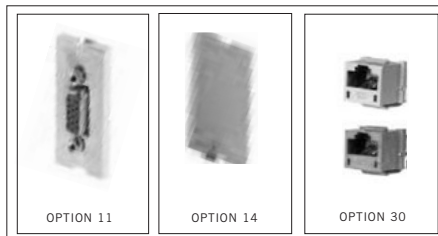

CONFIGURATION C

Consists of the following:

1x **OPTION 11** = \$109 LIST

1x **OPTION 14** = NO CHARGE

1x **OPTION 30** = \$54 LIST

TOTAL LIST = \$163 LIST

1X HDMI A/V CONNECTOR, 15 PIN V99 AND BLANK

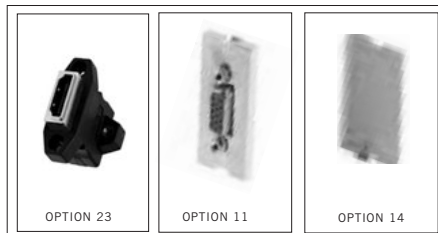

CONFIGURATION D

Consists of the following:

1x **OPTION 23** = \$345 LIST

1x **OPTION 11** = \$109 LIST

1x **OPTION 14** = NO CHARGE

TOTAL LIST = \$454 LIST