

TAILGATE TABLES



PRODUCT CODE



Series	Top Size	Top Shape	Series	Base	Finish
Tailgate Freestanding	Width x Length	B : Bullet RE : Rectangle RT : Racetrack BT : Boatshape REA : Rectangle Arc Ends	BTA : Boatshape Arc Ends EL : Ellipse VC : Video Conference VCA : Video Conference Arc Ends	Tailgate Freestanding	RE : Rectangle Plinth SQ : Square Plinth MNT2 : Manhattan Rect Double Column MRT2 : Manhattan Round Double Column
					L : Laminate V : Veneer

OPTIONS

BASES



Manhattan Round Double Column Manhattan Rectangular Double Column Plinth Base

VERTICAL WIRE MANAGER



Oval Vertical Wire Manager, with hinge door (shown on both columns) Rectangular Vertical Wire Manager, with removable door (shown on both columns)

FINISHES

LAMINATE

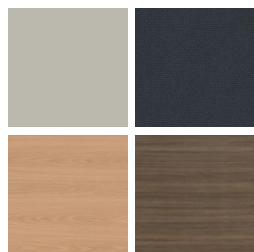

Select from 15 standard laminates or choose any standard Wilsonart, Nevamar, Formica, Arborite and Pionite matte finish laminates at no upcharge

VENEER



Select from one of our 9 standard wood stains or stain-to-match at no upcharge

BASE



Select from one of our 76 standard Spectone colors

EDGE

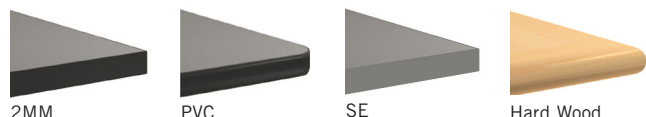

Check out our website for a complete list of edge profiles.

TAILGATE TABLES

HOW TO ORDER



Specify Series, Top Size (Width x Length) and Shape

- A** Specify Top Type and Finish
For Laminate Top: Manufacturer, Laminate Name, Laminate Code
For Veneer Top: Wood Stain
- B** Specify Edge Type, (for hardwood: Style), and Finish
PVC Flat/2mm Bio/2mm PVC Woodgrain/Self Edge/Hardwood
- C** Specify Base Style and Finish
For Laminate Base: Manufacturer, Laminate Name, Laminate Code
For Veneer Base: Wood Stain
For Metal Base: RAL Finish
 Optional: Vertical Wire Managers, Power and Data Modules

Series, Top Size and Shape	Top Finish	Edge Finish	Base Style and Finish	VWM Finish (if applicable)	Trough Size and Finish
TG, 55 x 66, Rectangle	Laminate, Arborite, Brown Sugar	Hardwood, HF, Custom Brown Sugar Stain	TGRE-L, Veneer, Arborite, Brown Sugar	n/a	40", Silver

TABLE TOPS

On one-piece tabletops, grain direction runs lengthwise. On tabletops of two or more pieces, grain direction runs from side-to-side, as standard.

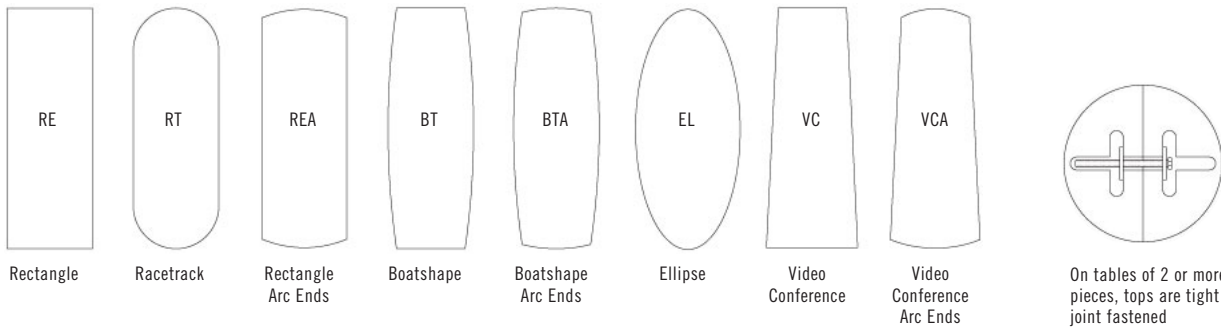

EDGE PROFILES

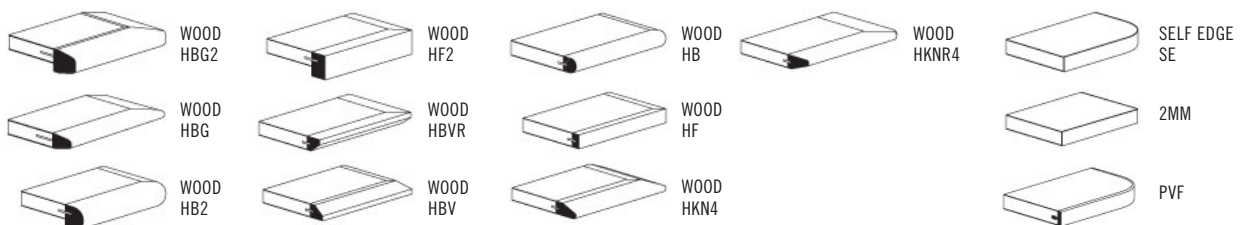



TAILGATE TABLES

TABLETOP

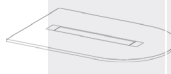

SIZE	TABLETOPS		TOP AND EDGE SPECIFICATIONS						TROUGHS		BASES		SEATS	LBS
	Model	Number of Sections	For Laminate Top			For Veneer Top			Number of Troughs	Length of Trough(s)	Number of Bases Required		Number of Seats	
SE PVF 2MM	HF HB	HBV HBVR HBG	HF2 HB2 HKN4 HKNR4 HBG2	HF HB HB2 HBV HBVR HBG	HF2 HB2 HKN4 HKNR4 HBG2	TGRE TGMNT2	TGSQ							
<i>Bullet</i>														
48 x 66	TG4866B	1	1865	2465	2647	2960	3037	3504	1	40	2	2	4	92
48 x 72	TG4872B	1	1961	2612	2810	3150	3236	3745	1	40	2	2	4	101
48 x 84	TG4884B	1	2351	3111	3343	3738	3838	4432	1	52	2	2	6	118
48 x 96	TG4896B	1	2535	3404	3668	4121	4234	4914	1	52	2	2	8	134
60 x 66	TG6066B	1	2017	2701	2910	3266	3355	3891	1	40	2	2	4	116
60 x 72	TG6072B	1	2121	2868	3095	3485	3582	4167	1	40	2	2	4	126
60 x 84	TG6084B	1	2538	3409	3675	4129	4243	4924	1	52	2	2	6	147
60 x 96	TG6096B	1	2749	3744	4048	4567	4697	5476	1	52	2	2	8	168

Price of top includes troughs and power duplexes. Number of duplexes varies depending on trough size and number of troughs per table. Trough door opens and closes from either side. An open perimeter around each side of the trough door allows the door to be closed while laptops and other items are plugged in.



BASES

MODEL	BASE SHAPE	LIST PRICE	LBS
TGRE-L	Rectangle Plinth, 11" x 22" - Laminate	828	60
TGRE-V	Rectangle Plinth, 11" x 22" - Veneer	978	60
TGSQ-L	Square Plinth, 22" x 22" - Laminate	828	70
TGSQ-V	Square Plinth, 22" x 22" - Veneer	978	70
TGMNT2	Manhattan Round Double Column	308	22
TGMRT2	Manhattan Rectangular Double Column	337	22
TGMNT2-VWM	Manhattan Round Double Column with 1 Oval Vertical Wire Manager	453	27
TGMNT2-RVWM	Manhattan Round Double Column with 1 Rectangular Vertical Wire Manager	453	27
TGMNT2-VWM2	Manhattan Round Double Column with 2 Oval Vertical Wire Managers	598	32
TGMNT2-RVWM2	Manhattan Round Double Column with 2 Rectangular Vertical Wire Managers	598	32

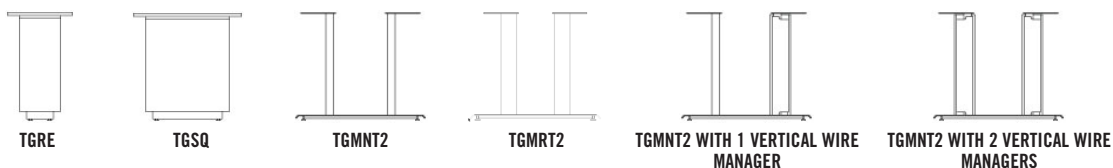

STANDARD FEATURES

- Select from 15 standard laminates or choose any standard Wilsonart, Nevamar, Formica, Arborite and Pionite matte finish laminates at no upcharge. For other laminate please contact the factory for pricing.
- 9 standard veneer and hardwood edge stains. Stain-to-match available at no upcharge.
- Standard with leveling glides.
- Plinth bases are standard with touch latch removable door.

- Plinth bases are standard with kickplate, finished in HOMAPAL 441 Brushed Natural Aluminum.
- Metal bases available in any Spectone color.
- Standard 29" table height.

OPTIONS

- For additional Power & Data modules, please see Table Accessories Price List.
- Cutout for wire pass-through at the bottom of Tailgate bases must be specified if required.

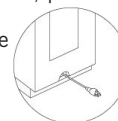

HOW TO ORDER

1. Select Top Size
2. Select Top Finish
3. Select Edge Style & Finish
4. Select Base
5. Select Base Finish

Example: 4896B - MNT2 -



TAILGATE TABLES

TABLETOP



SIZE	TABLETOPS		TOP AND EDGE SPECIFICATIONS						TROUGHS		BASES		SEATS	LBS
	Model	Number of Sections	For Laminate Top			For Veneer Top			Number of Troughs	Length of Trough(s)	Number of Bases Required		Number of Seats	
SE PVF 2MM	HF HB	HBV HBVR HBG	HF2 HB2 HKN4 HBGR4 HBG2	HF HB HB2 HKN4 HBVR HKNR4 HBG2	TGRE TGMNT2	TGSQ								
<i>Rectangle</i>														
48 x 96	TG4896RE	1	2157	2928	3138	3347	3664	4266	1	52	2	2	8	135
48 x 120	TG48120RE	2	2502	3500	3736	4245	4321	5025	1	76	3	2	10	168
48 x 144	TG48144RE	2	3320	4749	5062	5545	5430	6282	2	40	3	3	10	202
48 x 168	TG48168RE	2	4160	5599	5954	6632	6475	7464	2	52	3	3	12	236
48 x 192	TG48192RE	2	4435	6308	6741	7704	7374	8557	2	52	3	3	14	269
48 x 216	TG48216RE	2	5075	6931	7408	8432	8120	9453	2	76	3	3	14	303
60 x 120	TG60120RE	2	2913	4406	4730	5232	5114	6001	1	76	3	2	10	210
60 x 144	TG60144RE	2	3777	5566	5955	6559	6416	7477	2	40	3	3	12	252
60 x 168	TG60168RE	2	4572	6657	7109	7814	7647	8885	2	52	3	3	12	294
60 x 192	TG60192RE	2	5104	7605	8149	8997	8796	10281	2	52	3	3	14	336
60 x 216	TG60216RE	2	5621	8437	9050	10000	9774	11448	2	76	3	3	16	378

Price of top includes troughs and power duplexes. Number of duplexes varies depending on trough size and number of troughs per table. Trough door opens and closes from either side. An open perimeter around each side of the trough door allows the door to be closed while laptops and other items are plugged in.

BASES

MODEL	BASE SHAPE	LIST PRICE	LBS
TGRE-L	Rectangle Plinth, 11" x 22" - Laminate	828	60
TGRE-V	Rectangle Plinth, 11" x 22" - Veneer	978	60
TGSQ-L	Square Plinth, 22" x 22" - Laminate	828	70
TGSQ-V	Square Plinth, 22" x 22" - Veneer	978	70
TGMNT2	Manhattan Round Double Column	308	22
TGMRT2	Manhattan Rectangular Double Column	337	22
TGMNT2-VWM	Manhattan Round Double Column with 1 Oval Vertical Wire Manager	453	27
TGMNT2-RVWM	Manhattan Round Double Column with 1 Rectangular Vertical Wire Manager	453	27
TGMNT2-VWM2	Manhattan Round Double Column with 2 Oval Vertical Wire Managers	598	32
TGMNT2-RVWM2	Manhattan Round Double Column with 2 Rectangular Vertical Wire Managers	598	32



TGRE

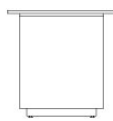

TGSQ

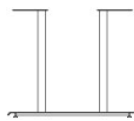

TGMNT2

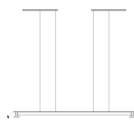

TGMRT2

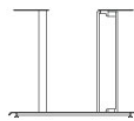

TGMNT2 WITH 1 VERTICAL WIRE MANAGER

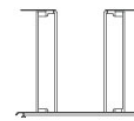

TGMNT2 WITH 2 VERTICAL WIRE MANAGERS

STANDARD FEATURES

- Select from 15 standard laminates or choose any standard Wilsonart, Nevamar, Formica, Arborite and Pionite matte finish laminates at no upcharge. For other laminate please contact the factory for pricing.
- 9 standard veneer and hardwood edge stains. Stain-to-match available at no upcharge.
- Standard with leveling glides.
- Plinth bases are standard with touch latch removable door.

- Plinth bases are standard with kickplate, finished in HOMAPAL 441 Brushed Natural Aluminum.
- Metal bases available in any Spectone color.
- Standard 29" table height.

OPTIONS

- For additional Power & Data modules, please see Table Accessories Price List.
- Cutout for wire pass-through at the bottom of Tailgate bases must be specified if required.

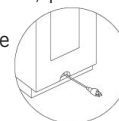

HOW TO ORDER

- Select Top Size
- Select Top Finish
- Select Edge Style & Finish
- Select Base
- Select Base Finish

Example: 4896RE - MNT2 -





TAILGATE TABLES

TABLETOP



SIZE	TABLETOPS		TOP AND EDGE SPECIFICATIONS						TROUGHS		BASES		SEATS	LBS
	Model	Number of Sections	SE PVF 2MM	HF HB	HBV HBVR HBG	HF2 HB2 HKN4 HBGR4 HBG2	For Veneer Top HF HB HB2 HKN4 HBVR HBG2	Number of Troughs	Length of Trough(s)	Number of Bases Required	TGRE TGMNT2	TGSQ	Number of Seats	
<i>Rectangle Arc Ends</i>														
48 x 96	TG4896REA	1	2173	3049	3260	3772	4132	4777	1	52	2	2	8	135
48 x 120	TG48120REA	2	2525	3909	4187	4893	4864	5617	1	76	3	2	10	168
48 x 144	TG48144REA	2	3347	5071	5413	6286	6084	6997	2	40	3	3	10	202
48 x 168	TG48168REA	2	4189	6064	6462	7432	7243	8302	2	52	3	3	12	236
48 x 192	TG48192REA	2	4347	6799	7268	8203	8455	9196	2	52	3	3	14	269
48 x 216	TG48216REA	2	5075	7509	8041	9200	9486	10208	2	76	3	3	14	303
60 x 120	TG60120REA	2	2905	4634	4980	5865	5826	6769	1	76	3	2	10	210
60 x 144	TG60144REA	2	3810	5965	6392	7488	7232	8372	2	40	3	3	12	252
60 x 168	TG60168REA	2	4760	7105	7602	8813	8578	9899	2	52	3	3	12	294
60 x 192	TG60192REA	2	5330	8146	8741	10194	10527	11500	2	52	3	3	14	336
60 x 216	TG60216REA	2	5877	9042	9713	11348	11723	12817	2	76	3	3	16	378

Price of top includes troughs and power duplexes. Number of duplexes varies depending on trough size and number of troughs per table. Trough door opens and closes from either side. An open perimeter around each side of the trough door allows the door to be closed while laptops and other items are plugged in.

BASES

MODEL	BASE SHAPE	LIST PRICE	LBS
TGRE-L	Rectangle Plinth, 11" x 22" - Laminate	828	60
TGRE-V	Rectangle Plinth, 11" x 22" - Veneer	978	60
TGSQ-L	Square Plinth, 22" x 22" - Laminate	828	70
TGSQ-V	Square Plinth, 22" x 22" - Veneer	978	70
TGMNT2	Manhattan Round Double Column	308	22
TGMRT2	Manhattan Rectangular Double Column	337	22
TGMNT2-VWM	Manhattan Round Double Column with 1 Oval Vertical Wire Manager	453	27
TGMNT2-RVWM	Manhattan Round Double Column with 1 Rectangular Vertical Wire Manager	453	27
TGMNT2-VWM2	Manhattan Round Double Column with 2 Oval Vertical Wire Managers	598	32
TGMNT2-RVWM2	Manhattan Round Double Column with 2 Rectangular Vertical Wire Managers	598	32

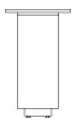

TGRE

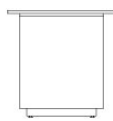

TGSQ

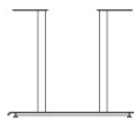

TGMNT2

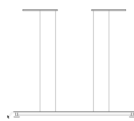

TGMRT2

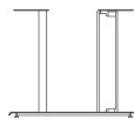

TGMNT2 WITH 1 VERTICAL WIRE MANAGER

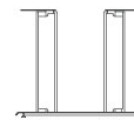

TGMNT2 WITH 2 VERTICAL WIRE MANAGERS

STANDARD FEATURES

- Select from 15 standard laminates or choose any standard Wilsonart, Nevamar, Formica, Arborite and Pionite matte finish laminates at no upcharge. For other laminate please contact the factory for pricing.
- 9 standard veneer and hardwood edge stains. Stain-to-match available at no upcharge.
- Standard with leveling glides.
- Plinth bases are standard with touch latch removable door.

- Plinth bases are standard with kickplate, finished in HOMAPAL 441 Brushed Natural Aluminum.
- Metal bases available in any Spectone color.
- Standard 29" table height.

OPTIONS

- For additional Power & Data modules, please see Table Accessories Price List.
- Cutout for wire pass-through at the bottom of Tailgate bases must be specified if required.

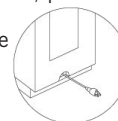

HOW TO ORDER

1. Select Top Size
2. Select Top Finish
3. Select Edge Style & Finish
4. Select Base
5. Select Base Finish

Example: 4896REA - MNT2 -





TAILGATE TABLES

TABLETOP



SIZE	TABLETOPS		TOP AND EDGE SPECIFICATIONS						TROUGHS		BASES		SEATS	LBS
	Model	Number of Sections	For Laminate Top			For Veneer Top			Number of Troughs	Length of Trough(s)	Number of Bases Required		Number of Seats	
SE PVF 2MM	HF HB	HBV HBVR HBG	HF2 HB2 HKN4 HBGR	HF HB HB2 HKN4 HBGR	Number of Troughs	Length of Trough(s)	TGRE TGMNT2	TGSQ						
<i>Racetrack</i>														
48 x 96	TG4896RT	1	2173	3049	3260	3772	4132	4777	1	52	2	2	8	135
48 x 120	TG48120RT	2	2525	3909	4187	4893	4864	5617	1	76	3	2	10	168
48 x 144	TG48144RT	2	3347	5071	5413	6286	6084	6997	2	40	3	3	10	202
48 x 168	TG48168RT	2	4189	6064	6462	7432	7243	8302	2	52	3	3	12	236
48 x 192	TG48192RT	2	4347	6799	7268	8203	8455	9196	2	52	3	3	14	269
48 x 216	TG48216RT	2	5075	7509	8041	9200	9486	10208	2	76	3	3	14	303
60 x 120	TG60120RT	2	2905	4634	4980	5865	5826	6769	1	76	3	2	10	210
60 x 144	TG60144RT	2	3810	5965	6392	7488	7232	8372	2	40	3	3	12	252
60 x 168	TG60168RT	2	4760	7105	7602	8813	8578	9899	2	52	3	3	12	294
60 x 192	TG60192RT	2	5330	8146	8741	10194	10527	11500	2	52	3	3	14	336
60 x 216	TG60216RT	2	5877	9042	9713	11348	11723	12817	2	76	3	3	16	378

Price of top includes troughs and power duplexes. Number of duplexes varies depending on trough size and number of troughs per table. Trough door opens and closes from either side. An open perimeter around each side of the trough door allows the door to be closed while laptops and other items are plugged in.

BASES

MODEL	BASE SHAPE	LIST PRICE	LBS
TGRE-L	Rectangle Plinth, 11" x 22" - Laminate	828	60
TGRE-V	Rectangle Plinth, 11" x 22" - Veneer	978	60
TGSQ-L	Square Plinth, 22" x 22" - Laminate	828	70
TGSQ-V	Square Plinth, 22" x 22" - Veneer	978	70
TGMNT2	Manhattan Round Double Column	308	22
TGMRT2	Manhattan Rectangular Double Column	337	22
TGMNT2-VWM	Manhattan Round Double Column with 1 Oval Vertical Wire Manager	453	27
TGMNT2-RVWM	Manhattan Round Double Column with 1 Rectangular Vertical Wire Manager	453	27
TGMNT2-VWM2	Manhattan Round Double Column with 2 Oval Vertical Wire Managers	598	32
TGMNT2-RVWM2	Manhattan Round Double Column with 2 Rectangular Vertical Wire Managers	598	32

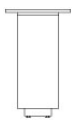

TGRE

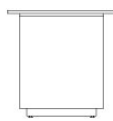

TGSQ

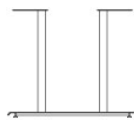

TGMNT2

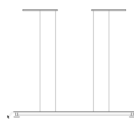

TGMRT2

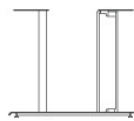

TGMNT2 WITH 1 VERTICAL WIRE MANAGER

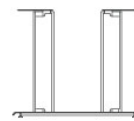

TGMNT2 WITH 2 VERTICAL WIRE MANAGERS

STANDARD FEATURES

- Select from 15 standard laminates or choose any standard Wilsonart, Nevamar, Formica, Arborite and Pionite matte finish laminates at no upcharge. For other laminate please contact the factory for pricing.
- 9 standard veneer and hardwood edge stains. Stain-to-match available at no upcharge.
- Standard with leveling glides.
- Plinth bases are standard with touch latch removable door.

- Plinth bases are standard with kickplate, finished in HOMAPAL 441 Brushed Natural Aluminum.
- Metal bases available in any Spectone color.
- Standard 29" table height.

OPTIONS

- For additional Power & Data modules, please see Table Accessories Price List.
- Cutout for wire pass-through at the bottom of Tailgate bases must be specified if required.

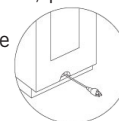

HOW TO ORDER

1. Select Top Size
2. Select Top Finish
3. Select Edge Style & Finish
4. Select Base
5. Select Base Finish

Example: 4896RT - MNT2 -





TAILGATE TABLES

TABLETOP



SIZE	TABLETOPS		TOP AND EDGE SPECIFICATIONS						TROUGHS		BASES		SEATS	LBS
	Model	Number of Sections	For Laminate Top			For Veneer Top			Number of Troughs	Length of Trough(s)	Number of Bases Required		Number of Seats	
SE PVF 2MM	HF HB	HBV HBVR HBG	HF2 HB2 HKN4 HKNR4 HBG2	HF HB HBV HBVR HBG	HF2 HB2 HKN4 HKNR4 HBG2	TGRE TGMNT2	TGSQ							
<i>Boatshape</i>														
48 x 96	TG4896BT	1	2173	3640	3915	4198	4596	4948	1	52	2	2	8	135
48 x 120	TG48120BT	2	2525	4562	4903	5260	5412	5817	1	76	3	2	10	168
48 x 144	TG48144BT	2	3347	5723	6129	6559	7101	7467	2	40	3	3	10	202
48 x 168	TG48168BT	2	4189	6787	7257	7753	8005	8577	2	52	3	3	12	236
48 x 192	TG48192BT	2	4347	7533	8076	9149	9439	10290	2	52	3	3	14	269
48 x 216	TG48216BT	2	5075	8330	8943	10275	10605	11435	2	76	3	3	14	303
60 x 120	TG60120BT	2	2905	5449	5876	6321	6515	7018	1	76	3	2	10	210
60 x 144	TG60144BT	2	3810	6782	7288	7824	8500	8962	2	40	3	3	12	252
60 x 168	TG60168BT	2	4760	8007	8594	9215	9530	10245	2	52	3	3	12	294
60 x 192	TG60192BT	2	5330	9227	9933	10676	11052	11910	2	52	3	3	14	336
60 x 216	TG60216BT	2	5877	10262	11054	11892	12315	13279	2	76	3	3	16	378

Price of top includes troughs and power duplexes. Number of duplexes varies depending on trough size and number of troughs per table. Trough door opens and closes from either side. An open perimeter around each side of the trough door allows the door to be closed while laptops and other items are plugged in.

BASES

MODEL	BASE SHAPE	LIST PRICE	LBS
TGRE-L	Rectangle Plinth, 11" x 22" - Laminate	828	60
TGRE-V	Rectangle Plinth, 11" x 22" - Veneer	978	60
TGSQ-L	Square Plinth, 22" x 22" - Laminate	828	70
TGSQ-V	Square Plinth, 22" x 22" - Veneer	978	70
TGMNT2	Manhattan Round Double Column	308	22
TGMRT2	Manhattan Rectangular Double Column	337	22
TGMNT2-VWM	Manhattan Round Double Column with 1 Oval Vertical Wire Manager	453	27
TGMNT2-RVWM	Manhattan Round Double Column with 1 Rectangular Vertical Wire Manager	453	27
TGMNT2-VWM2	Manhattan Round Double Column with 2 Oval Vertical Wire Managers	598	32
TGMNT2-RVWM2	Manhattan Round Double Column with 2 Rectangular Vertical Wire Managers	598	32

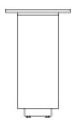

TGRE

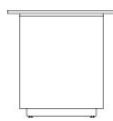

TGSQ

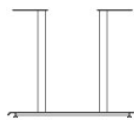

TGMNT2

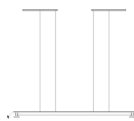

TGMRT2

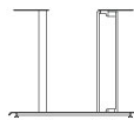

TGMNT2 WITH 1 VERTICAL WIRE MANAGER

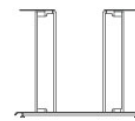

TGMNT2 WITH 2 VERTICAL WIRE MANAGERS

STANDARD FEATURES

- Select from 15 standard laminates or choose any standard Wilsonart, Nevamar, Formica, Arborite and Pionite matte finish laminates at no upcharge. For other laminate please contact the factory for pricing.
- 9 standard veneer and hardwood edge stains. Stain-to-match available at no upcharge.
- Standard with leveling glides.
- Plinth bases are standard with touch latch removable door.

- Plinth bases are standard with kickplate, finished in HOMAPAL 441 Brushed Natural Aluminum.
- Metal bases available in any Spectone color.
- Standard 29" table height.

OPTIONS

- For additional Power & Data modules, please see Table Accessories Price List.
- Cutout for wire pass-through at the bottom of Tailgate bases must be specified if required.

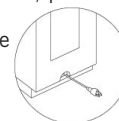

HOW TO ORDER

1. Select Top Size
2. Select Top Finish
3. Select Edge Style & Finish
4. Select Base
5. Select Base Finish

Example: 4896BT - MNT2 -





TAILGATE TABLES

TABLETOP



SIZE	TABLETOPS		TOP AND EDGE SPECIFICATIONS						TROUGHS		BASES		SEATS	LBS
	Model	Number of Sections	SE PVF 2MM	HF HB	HBV HBVR HBG	HF2 HB2 HKN4 HKNR4 HBG2	For Veneer Top HF HB HBV HBVR HBG	HF2 HB2 HKN4 HKNR4 HBG2	Number of Troughs	Length of Trough(s)	Number of Bases Required	TGRE TGMNT2	TGSQ	Number of Seats
<i>Boatshape Arc Ends</i>														
48 x 96	TG4896BTA	1	2324	4114	4386	4669	5065	5419	1	52	2	2	8	135
48 x 120	TG48120BTA	2	2674	5034	5373	5729	5881	6287	1	76	3	2	10	168
48 x 144	TG48144BTA	2	3496	6194	6599	7027	7569	7938	2	40	3	3	10	202
48 x 168	TG48168BTA	2	4340	7257	7726	8223	8475	9048	2	52	3	3	12	236
48 x 192	TG48192BTA	2	4590	8094	8691	9872	10192	11129	2	52	3	3	14	269
48 x 216	TG48216BTA	2	5380	8963	9636	11101	11464	12375	2	76	3	3	14	303
60 x 120	TG60120BTA	2	3091	6038	6462	6910	7098	7604	1	76	3	2	10	210
60 x 144	TG60144BTA	2	3996	7369	7876	8413	9087	9548	2	40	3	3	12	252
60 x 168	TG60168BTA	2	4948	8594	9182	9801	10116	10831	2	52	3	3	12	294
60 x 192	TG60192BTA	2	5554	9933	10638	11377	11758	12616	2	52	3	3	14	336
60 x 216	TG60216BTA	2	6130	11054	11847	12683	13107	14073	2	76	3	3	16	378

Price of top includes troughs and power duplexes. Number of duplexes varies depending on trough size and number of troughs per table. Trough door opens and closes from either side. An open perimeter around each side of the trough door allows the door to be closed while laptops and other items are plugged in.

BASES

MODEL	BASE SHAPE	LIST PRICE	LBS
TGRE-L	Rectangle Plinth, 11" x 22" - Laminate	828	60
TGRE-V	Rectangle Plinth, 11" x 22" - Veneer	978	60
TGSQ-L	Square Plinth, 22" x 22" - Laminate	828	70
TGSQ-V	Square Plinth, 22" x 22" - Veneer	978	70
TGMNT2	Manhattan Round Double Column	308	22
TGMRT2	Manhattan Rectangular Double Column	337	22
TGMNT2-VWM	Manhattan Round Double Column with 1 Oval Vertical Wire Manager	453	27
TGMNT2-RVWM	Manhattan Round Double Column with 1 Rectangular Vertical Wire Manager	453	27
TGMNT2-VWM2	Manhattan Round Double Column with 2 Oval Vertical Wire Managers	598	32
TGMNT2-RVWM2	Manhattan Round Double Column with 2 Rectangular Vertical Wire Managers	598	32



TGRE

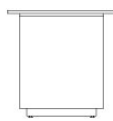

TGSQ

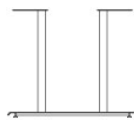

TGMNT2

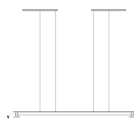

TGMRT2

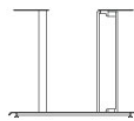

TGMNT2 WITH 1 VERTICAL WIRE MANAGER

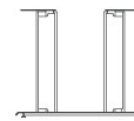

TGMNT2 WITH 2 VERTICAL WIRE MANAGERS

STANDARD FEATURES

- Select from 15 standard laminates or choose any standard Wilsonart, Nevamar, Formica, Arborite and Pionite matte finish laminates at no upcharge. For other laminate please contact the factory for pricing.
- 9 standard veneer and hardwood edge stains. Stain-to-match available at no upcharge.
- Standard with leveling glides.
- Plinth bases are standard with touch latch removable door.

- Plinth bases are standard with kickplate, finished in HOMAPAL 441 Brushed Natural Aluminum.
- Metal bases available in any Spectone color.
- Standard 29" table height.

OPTIONS

- For additional Power & Data modules, please see Table Accessories Price List.
- Cutout for wire pass-through at the bottom of Tailgate bases must be specified if required.

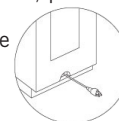

HOW TO ORDER

1. Select Top Size
2. Select Top Finish
3. Select Edge Style & Finish
4. Select Base
5. Select Base Finish

Example: 4896BTA - MNT2 -





TAILGATE TABLES

TABLETOP



SIZE	TABLETOPS		TOP AND EDGE SPECIFICATIONS						TROUGHS		BASES		SEATS	LBS
	Model	Number of Sections	SE PVF 2MM	HF HB	HBV HBVR HBG	HF2 HB2 HKN4 HKNR4 HBG2	For Veneer Top HF HB HBV HBVR HBG	HF2 HB2 HKN4 HKNR4 HBG2	Number of Troughs	Length of Trough(s)	Number of Bases Required	TGRE TGMNT2	TGSQ	Number of Seats
<i>Ellipse</i>														
48 x 96	TG4896EL	1	2419	4179	4509	4848	5324	5746	1	52	2	2	8	135
48 x 120	TG48120EL	2	2828	5272	5681	6108	6294	6776	1	76	3	2	10	168
48 x 144	TG48144EL	2	3716	6570	7056	7572	8220	8664	2	40	3	3	10	202
48 x 168	TG48168EL	2	4646	7762	8327	8920	9202	9912	2	52	3	3	12	236
48 x 192	TG48192EL	2	4860	8715	9370	10667	11020	12050	2	52	3	3	14	269
48 x 216	TG48216EL	2	5716	9657	10395	12010	12409	13410	2	76	3	3	14	303
60 x 120	TG60120EL	2	3404	6794	7279	7794	8012	8592	1	76	3	2	10	210
60 x 144	TG60144EL	2	4372	8250	8833	9451	10226	10755	2	40	3	3	12	252
60 x 168	TG60168EL	2	5404	9597	10272	10984	11347	12170	2	52	3	3	12	294
60 x 192	TG60192EL	2	6103	11135	11947	12800	13235	14224	2	52	3	3	14	336
60 x 216	TG60216EL	2	6746	12408	13320	14280	14769	15882	2	76	3	3	16	378

Price of top includes troughs and power duplexes. Number of duplexes varies depending on trough size and number of troughs per table. Trough door opens and closes from either side. An open perimeter around each side of the trough door allows the door to be closed while laptops and other items are plugged in.

BASES

MODEL	BASE SHAPE	LIST PRICE	LBS
TGRE-L	Rectangle Plinth, 11" x 22" - Laminate	828	60
TGRE-V	Rectangle Plinth, 11" x 22" - Veneer	978	60
TGSQ-L	Square Plinth, 22" x 22" - Laminate	828	70
TGSQ-V	Square Plinth, 22" x 22" - Veneer	978	70
TGMNT2	Manhattan Round Double Column	308	22
TGMRT2	Manhattan Rectangular Double Column	337	22
TGMNT2-VWM	Manhattan Round Double Column with 1 Oval Vertical Wire Manager	453	27
TGMNT2-RVWM	Manhattan Round Double Column with 1 Rectangular Vertical Wire Manager	453	27
TGMNT2-VWM2	Manhattan Round Double Column with 2 Oval Vertical Wire Managers	598	32
TGMNT2-RVWM2	Manhattan Round Double Column with 2 Rectangular Vertical Wire Managers	598	32



TGRE

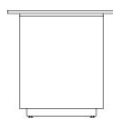

TGSQ

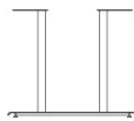

TGMNT2

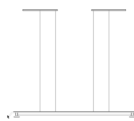

TGMRT2

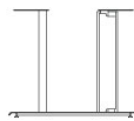

TGMNT2 WITH 1 VERTICAL WIRE MANAGER

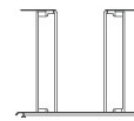

TGMNT2 WITH 2 VERTICAL WIRE MANAGERS

STANDARD FEATURES

- Select from 15 standard laminates or choose any standard Wilsonart, Nevamar, Formica, Arborite and Pionite matte finish laminates at no upcharge. For other laminate please contact the factory for pricing.
- 9 standard veneer and hardwood edge stains. Stain-to-match available at no upcharge.
- Standard with leveling glides.
- Plinth bases are standard with touch latch removable door.

- Plinth bases are standard with kickplate, finished in HOMAPAL 441 Brushed Natural Aluminum.
- Metal bases available in any Spectone color.
- Standard 29" table height.

OPTIONS

- For additional Power & Data modules, please see Table Accessories Price List.
- Cutout for wire pass-through at the bottom of Tailgate bases must be specified if required.

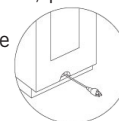

HOW TO ORDER

1. Select Top Size
2. Select Top Finish
3. Select Edge Style & Finish
4. Select Base
5. Select Base Finish

Example: 4896EL - MNT2 -





TAILGATE TABLES

TABLETOP

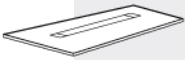

SIZE	TABLETOPS		TOP AND EDGE SPECIFICATIONS						TROUGHS		BASES		SEATS	LBS
	Model	Number of Sections	For Laminate Top			For Veneer Top			Number of Troughs	Length of Trough(s)	Number of Bases Required		Number of Seats	
SE PVF 2MM	HF HB	HBV HBVR HBG	HF2 HB2 HKN4 HKNR4 HBG2	HF HB HBV HBVR HBG	HF2 HB2 HKN4 HKNR4 HBG2	TGRE TGMNT2	TGSQ							
<i>Video Conference</i>														
48 x 96	TG4896VC	1	2173	3640	3915	4198	4596	4948	1	52	2	2	8	135
48 x 120	TG48120VC	2	2525	4562	4903	5260	5412	5817	1	76	3	2	10	168
48 x 144	TG48144VC	2	3347	5723	6129	6559	7101	7467	2	40	3	3	10	202
48 x 168	TG48168VC	2	4189	6787	7257	7753	7986	8577	2	52	3	3	12	236
48 x 192	TG48192VC	2	4347	7533	8076	9149	9439	10290	2	52	3	3	14	269
48 x 216	TG48216VC	2	5075	8330	8943	10275	10605	11435	2	76	3	3	14	303
60 x 120	TG60120VC	2	2905	5449	5876	6321	6515	7018	1	76	3	2	10	210
60 x 144	TG60144VC	2	3810	6782	7288	7824	8500	8962	2	40	3	3	12	252
60 x 168	TG60168VC	2	4760	8007	8594	9215	9530	10245	2	52	3	3	12	294
60 x 192	TG60192VC	2	5330	9227	9933	10676	11052	11910	2	52	3	3	14	336
60 x 216	TG60216VC	2	5877	10262	11054	11892	12315	13279	2	76	3	3	16	378

Price of top includes troughs and power duplexes. Number of duplexes varies depending on trough size and number of troughs per table. Trough door opens and closes from either side. An open perimeter around each side of the trough door allows the door to be closed while laptops and other items are plugged in.

BASES

MODEL	BASE SHAPE	LIST PRICE	LBS
TGRE-L	Rectangle Plinth, 11" x 22" - Laminate	828	60
TGRE-V	Rectangle Plinth, 11" x 22" - Veneer	978	60
TGSQ-L	Square Plinth, 22" x 22" - Laminate	828	70
TGSQ-V	Square Plinth, 22" x 22" - Veneer	978	70
TGMNT2	Manhattan Round Double Column	308	22
TGMRT2	Manhattan Rectangular Double Column	337	22
TGMNT2-VWM	Manhattan Round Double Column with 1 Oval Vertical Wire Manager	453	27
TGMNT2-RVWM	Manhattan Round Double Column with 1 Rectangular Vertical Wire Manager	453	27
TGMNT2-VWM2	Manhattan Round Double Column with 2 Oval Vertical Wire Managers	598	32
TGMNT2-RVWM2	Manhattan Round Double Column with 2 Rectangular Vertical Wire Managers	598	32

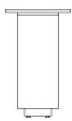

TGRE

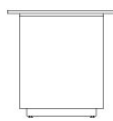

TGSQ

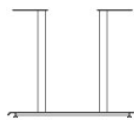

TGMNT2

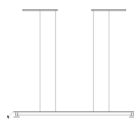

TGMRT2

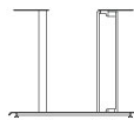

TGMNT2 WITH 1 VERTICAL WIRE MANAGER

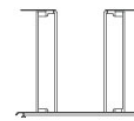

TGMNT2 WITH 2 VERTICAL WIRE MANAGERS

STANDARD FEATURES

- Select from 15 standard laminates or choose any standard Wilsonart, Nevamar, Formica, Arborite and Pionite matte finish laminates at no upcharge. For other laminate please contact the factory for pricing.
- 9 standard veneer and hardwood edge stains. Stain-to-match available at no upcharge.
- Standard with leveling glides.
- Plinth bases are standard with touch latch removable door.

- Plinth bases are standard with kickplate, finished in HOMAPAL 441 Brushed Natural Aluminum.
- Metal bases available in any Spectone color.
- Standard 29" table height.

OPTIONS

- For additional Power & Data modules, please see Table Accessories Price List.
- Cutout for wire pass-through at the bottom of Tailgate bases must be specified if required.

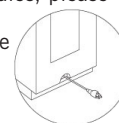

HOW TO ORDER

1. Select Top Size
2. Select Top Finish
3. Select Edge Style & Finish
4. Select Base
5. Select Base Finish

Example: 4896VC - MNT2 -





TAILGATE TABLES

TABLETOP

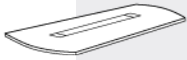

SIZE	TABLETOPS		TOP AND EDGE SPECIFICATIONS						TROUGHS		BASES		SEATS	LBS
	Model	Number of Sections	SE PVF 2MM	HF HB	HBV HBVR HBG	HF2 HB2 HKN4 HKNR4 HBG2	For Veneer Top HF HB HBV HBVR HBG	HF2 HB2 HKN4 HKNR4 HBG2	Number of Troughs	Length of Trough(s)	Number of Bases Required	TGRE TGMNT2	TGSQ	Number of Seats
<i>Video Conference Arc Ends</i>														
48 x 96	TG4896VCA	1	2324	4114	4386	4669	5065	5419	1	52	2	2	8	135
48 x 120	TG48120VCA	2	2674	5034	5373	5729	5881	6287	1	76	3	2	10	168
48 x 144	TG48144VCA	2	3496	6194	6599	7027	7569	7938	2	40	3	3	10	202
48 x 168	TG48168VCA	2	4340	7257	7726	8223	8475	9048	2	52	3	3	12	236
48 x 192	TG48192VCA	2	4590	8094	8691	9872	10192	11129	2	52	3	3	14	269
48 x 216	TG48216VCA	2	5380	8963	9636	11101	11464	12375	2	76	3	3	14	303
60 x 120	TG60120VCA	2	3091	6038	6462	6910	7098	7604	1	76	3	2	10	210
60 x 144	TG60144VCA	2	3996	7369	7876	8413	9087	9548	2	40	3	3	12	252
60 x 168	TG60168VCA	2	4948	8594	9182	9801	10116	10831	2	52	3	3	12	294
60 x 192	TG60192VCA	2	5554	9933	10638	11377	11758	12616	2	52	3	3	14	336
60 x 216	TG60216VCA	2	6130	11054	11847	12683	13107	14073	2	76	3	3	16	378

Price of top includes troughs and power duplexes. Number of duplexes varies depending on trough size and number of troughs per table. Trough door opens and closes from either side. An open perimeter around each side of the trough door allows the door to be closed while laptops and other items are plugged in.

BASES

MODEL	BASE SHAPE	LIST PRICE	LBS
TGRE-L	Rectangle Plinth, 11" x 22" - Laminate	828	60
TGRE-V	Rectangle Plinth, 11" x 22" - Veneer	978	60
TGSQ-L	Square Plinth, 22" x 22" - Laminate	828	70
TGSQ-V	Square Plinth, 22" x 22" - Veneer	978	70
TGMNT2	Manhattan Round Double Column	308	22
TGMRT2	Manhattan Rectangular Double Column	337	22
TGMNT2-VWM	Manhattan Round Double Column with 1 Oval Vertical Wire Manager	453	27
TGMNT2-RVWM	Manhattan Round Double Column with 1 Rectangular Vertical Wire Manager	453	27
TGMNT2-VWM2	Manhattan Round Double Column with 2 Oval Vertical Wire Managers	598	32
TGMNT2-RVWM2	Manhattan Round Double Column with 2 Rectangular Vertical Wire Managers	598	32



TGRE

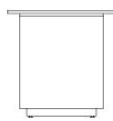

TGSQ

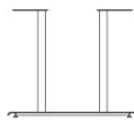

TGMNT2

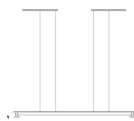

TGMRT2

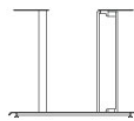

TGMNT2 WITH 1 VERTICAL WIRE MANAGER

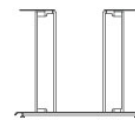

TGMNT2 WITH 2 VERTICAL WIRE MANAGERS

STANDARD FEATURES

- Select from 15 standard laminates or choose any standard Wilsonart, Nevamar, Formica, Arborite and Pionite matte finish laminates at no upcharge. For other laminate please contact the factory for pricing.
- 9 standard veneer and hardwood edge stains. Stain-to-match available at no upcharge.
- Standard with leveling glides.
- Plinth bases are standard with touch latch removable door.

- Plinth bases are standard with kickplate, finished in HOMAPAL 441 Brushed Natural Aluminum.
- Metal bases available in any Spectone color.
- Standard 29" table height.

OPTIONS

- For additional Power & Data modules, please see Table Accessories Price List.
- Cutout for wire pass-through at the bottom of Tailgate bases must be specified if required.

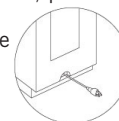

HOW TO ORDER

1. Select Top Size
2. Select Top Finish
3. Select Edge Style & Finish
4. Select Base
5. Select Base Finish

Example: 4896VCA - MNT2 -





TAILGATE TABLES

POWER AND VOICE/DATA ACCESSORIES

Power and Communication Trough is included in price.

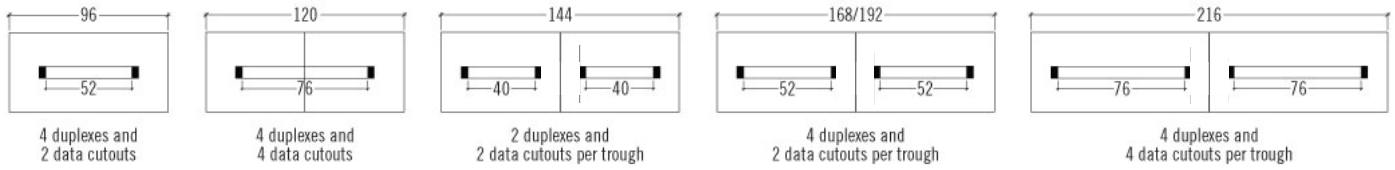

Each trough is standard with power duplexes (labelled P) with a 9 ft. cord. Cutouts for data and communication (labelled D) are also included, however, data ports must be specified separately and can be configured to meet specific requirements. Specify blank plates when data and communication is not required at no upcharge.

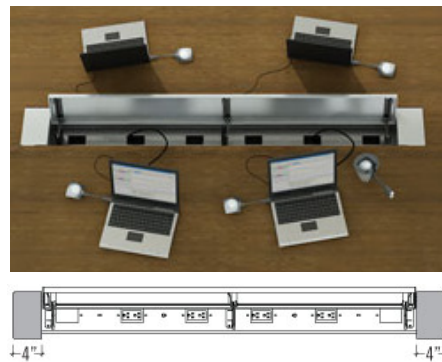
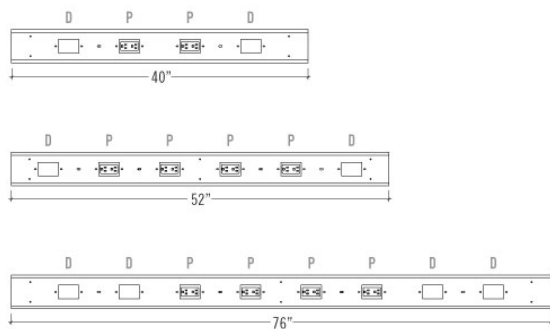

Trough end caps are always 4" long and 6.5" wide.



Units in data plates must equal 3. Plates can be made up of items that equal 1 unit each for a total of 3 units or a combination of items that total 3 units.

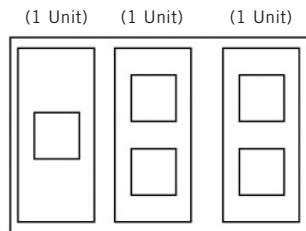

OPTION 11 - \$113 List
15 Pin VGA
(1 Unit)
Front: 15 Pin Female
Back: 15 Pin Female



OPTION 14 - No Charge
Blank
(1 Unit)



OPTION 33 - \$125
3.5mm Stereo (F/F)
(1 Unit)



OPTION 30 - \$56 List
RJ 11 (cat. 3)/
RJ 45 (cat. 6)
(1 Unit)



OPTION 17 - \$63 List
RJ 11 (cat. 3) X 2
(1 Unit)



OPTION 28 - \$47 List
RJ 45 (cat. 6) X 2
(1 Unit)



OPTION 19 - \$36 List
RJ 11 (cat. 3) X 1
(1 Unit)



OPTION 29 - \$26 List
RJ 45 (cat. 6) X 1
(1 Unit)



OPTION 21 - \$278 List
USB 2.0 Performance
(1 Unit)
Front: Type A & B (F/F)
Back: Type A & B (F/F)



OPTION 22 - \$146 List
USB 2.0 Performance
(1 Unit)
Front: Type A & A (F/F)
Back: Type A & A (F/F)



OPTION 23 - \$99 List
HDMI-A/V Connector
(1 Unit)
Front: Female
Back: Female



OPTION 32 - \$174 List
RJ 45 (cat. 6)
USB 2.0 (F/F) Type A & A
(1 Unit)

TAILGATE TABLES

VOICE/DATA ACCESSORIES

Examples of 1 Data Plate

PLATE CONFIGURATION OPTIONS FOR DATA & PHONE

6X RJ 45 (CAT. 6)

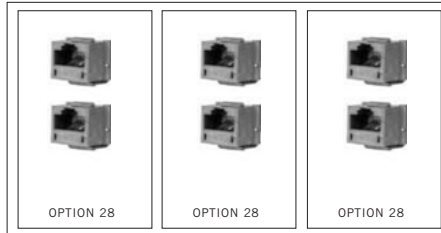

CONFIGURATION A

Consists of the following:

3x **OPTION 28** = \$47 LIST

TOTAL LIST = \$141 LIST

1X RJ 11 (CAT. 3), AND 5X RJ 45 (CAT. 6)

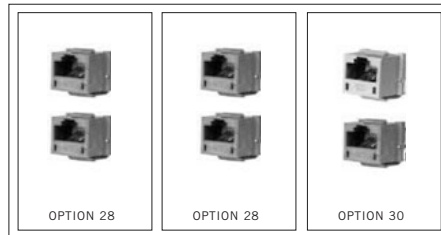

CONFIGURATION B

Consists of the following:

1x **OPTION 30** = \$56 LIST

2x **OPTION 28** = \$47 LIST

TOTAL LIST = \$150 LIST



PLATE CONFIGURATION OPTIONS FOR AUDIO/VIDEO

1X 15 PIN VGA, BLANK AND RJ 11, RJ 45 (CAT. 6)

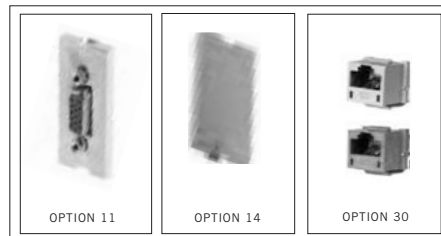

CONFIGURATION C

Consists of the following:

1x **OPTION 11** = \$113 LIST

1x **OPTION 14** = NO CHARGE

1x **OPTION 30** = \$56 LIST

TOTAL LIST = \$169 LIST

1X HDMI A/V CONNECTOR, 15 PIN V99 AND BLANK

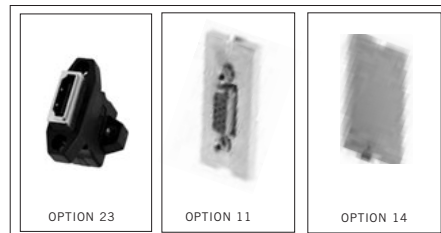

CONFIGURATION D

Consists of the following:

1x **OPTION 23** = \$99 LIST

1x **OPTION 11** = \$113 LIST

1x **OPTION 14** = NO CHARGE

TOTAL LIST = \$212 LIST